

FORM-1/ (APPENDIX - I)

FOR

**Proposed 150 KLPD
Grain based Ethanol Plant along with
3.5 MW Cogeneration Power Plant**

At

**Plot No. 4, Growth Centre Begusarai Industrial Area,
Village Asurari, Tehsil Barauni, Begusarai, Bihar**

APPLICANT

New Way Homes Private Limited

**Regd. Office: GF-11 Ground Floor,
Prakash Deep Building, 7 Tolstoy Marg, New Delhi - 110001**

Phone No.: +91-75450 05566;

Email: vats@semjcb.com

APPENDIX – I
(See paragraph – 6)
FORM 1

(I) Basic Information

1.	Name of the Project	:	Proposed 150 KLPD Grain based Ethanol Plant along with 3.5 MW Co-generation power plant at Plot No. 4, Growth Centre Begusarai Industrial Area, Village Asurari, Tehsil Barauni, Begusarai, Bihar by M/s. New Way Homes Private Limited
2.	S. No. in the schedule	:	The proposed activity is covered under MoEFCC Notification S.O. 2339(E) dated 16th June, 2021 a special provision in the EIA Notification, 2006- (Schedule 5 (ga), Category B2). As per the notification, Grain based distilleries with Zero Liquid Discharge producing ethanol; solely to be used for Ethanol Blended Petrol Programme of the Government of India shall be considered under B2 Category with condition that the project proponent shall file a notarized affidavit that ethanol produced from proposed project shall be used completely for EBP Programme.
3.	Proposed capacity /area/length/tonnage to be handled/command area/lease area/number of wells to be drilled	:	<ul style="list-style-type: none"> • Proposed Capacity – 150 KLPD Grain Based ethanol plant and 3.5 MW Co-generation Power Plant • Total Project Area = 8.09 hectares (20 Acres)
4.	New/Expansion/Modernization	:	New
5.	Existing Capacity/Area etc	:	Not applicable
6.	Category of Project i.e. 'A' or 'B'	:	Category 'B2'
7.	Does it attract the general condition? If yes, please specify	:	No, it does not attract the general condition.
8.	Does it attract the specific condition? If yes, please specify.	:	No, it does not attract the specific condition.
9.	Location	:	
	Plot/ Survey / Khasra No.	:	Plot No. 4, Growth Centre Begusarai Industrial Area
	Village	:	Asurari
	Tehsil	:	Barauni
	District	:	Begusarai
	State	:	Bihar
10	Nearest railway station/airport	:	• Nearest Railway Station: Barauni Junction Railway Station (~4.0 km

Proposed 150 KLPD Grain based Ethanol Plant along with 3.5 MW Cogeneration Power Plant
At Plot No. 4, Growth Centre Begusarai Industrial Area, Village Asurari, Tehsil Barauni, Begusarai, Bihar

Form-1 / Appendix-I

	along with distance in KMs		in WSW direction) • Nearest Airport: Jayprakash Narayan International Airport, Patna (~96 km in WNW direction)
11.	Nearest Town, City, District Headquarters along with distance in Kms.	:	Barauni (~3.8 km in West direction) Begusarai (~9.0 km in ESE direction)
12.	Village Panchayats, Zilla Parishad, Municipal Corporation, Local body (complete postal addresses with telephone nos. to be given)	:	Begusarai Municipal Corporation Sri Pandey Arbind Anurup, City Manager Telephone No.: 06243222095; Mobile No.:8969000283 Email ID: citymanager.begusarai@bihar.gov.in
13.	Name of the applicant	:	M/s New Way Homes Private Limited
14.	Registered Address	:	GF-II Ground Floor, Prakash Deep Building, 7 Tolstoy Marg, New Delhi-110001
15.	Address for correspondence:		
	Name	:	Sanjay Kumar Singh
	Designation (Owner/Partner/CEO)	:	Director
	Address	:	GF-II Ground Floor, Prakash Deep Building, 7 Tolstoy Marg, New Delhi
	Pin Code	:	110001
	E-mail	:	vats@semjcb.com
	Telephone No.	:	7545005566
	Fax No.	:	Nil
16.	Details of Alternative Sites examined, if any. Location of these sites should be shown on a topo sheet	:	No alternative site has been taken into consideration since the land has been allotted by Bihar Industrial Area Development Authority (BIADA).
17.	Interlinked Projects	:	There are no interlinked projects related to this project.
18.	Whether separate application of interlinked project has been submitted	:	Not Applicable
19.	If yes, date of submission	:	Not Applicable
20.	If no, reason	:	Not Applicable
21.	Whether the proposal involves approval/clearance under: If yes,	:	The proposal does not involve any approval /clearance under any act as mentioned in the condition.

	details of the same and the status to be given (a) The Forest (Conservation) Act, 1980 (b) The Wildlife (Protection) Act, 1972 (c) The C.R.Z Notification, 1991		No No No
22.	Whether there is any Government Order/Policy relevant/relating to the site	:	No Government Order/Policy is issued relevant for the project site.
23.	Forest land involved (hectares)	:	No forest land is involved in the project.
24.	Whether there is any litigation pending against the project and / or land in which the project is proposed to be set up (a) Name of the Court (b) Case No. (c) Orders/directions of the Court, if any and its relevance with the proposed project.	:	No litigation is pending against the project.

(II) Activity

1. Construction, operation or decommissioning of the Project involving actions, which will cause physical changes in the locality (topography, land use, changes in water bodies, etc.)

S. No.	Information/Checklist confirmation	Yes/ No	Details there of (with approximate quantities /rates, wherever possible) with source of information data
1.1	Permanent or temporary change in land use, land cover or topography including increase in intensity of land use (with respect to local land use plan)	Yes	Total land area required for the proposed project is 8.09 ha (20.0 acres); which is already under the possession of the company and is industrial in nature. The land has been allotted to the company by Bihar Industrial Area Development Authority (BIADA). There will not be any change in land use; only intensity will increase due to operations of ethanol plant. 33% of total area will be developed under greenbelt & plantation, which will contribute to increase the aesthetic beauty of the area and reduction of pollution.
1.2	Clearance of existing land, vegetation	Yes	The proposed project site is more or less flat and only little

	and buildings?		leveling, cutting and filling of ground will be required for construction. Vegetation is scattered in the form of bushes which will be cleared for the construction of various units of proposed Ethanol Plant.
1.3	Creation of new land uses?	No	Total land area required for the proposed project is 8.09 ha (20.0 acres); which is already under the possession of the company and is industrial in nature. The land has been allotted to the company by Bihar Industrial Area Development Authority (BIADA). There will not be any change in land use; only intensity will increase due to operations of ethanol plant.
1.4	Pre-construction investigations e.g. bore houses, soil testing?	Yes	Site specific geotechnical and sub-surface investigations will be carried out before construction of Ethanol Plant & Power Plant.
1.5	Construction works?	Yes	Construction will be done for installation of Ethanol Plant, power plant and required storage facilities & utilities etc.
1.6	Demolition works?	No	No demolition works envisaged.
1.7	Temporary sites used for construction works or housing of construction workers?	Yes	Local people will be preferred for the construction purpose; housing facilities may not be required for them. However, all required amenities / facilities will be provided for construction workers at site such as rest shelters, portable toilet, facilities for drinking water etc.
1.8	Above ground buildings, structures or earthworks including linear structures, cut and fill or excavations	Yes	There will be excavation, cut and fill during the process of construction / erection of proposed project.
1.9	Underground works including mining or tunneling?	Yes	Underground works like mining or tunneling are not envisaged, however for construction of ethanol plant & power plant subsurface work like laying of foundation, piling etc. will be done as part of civil construction.
1.10	Reclamation works?	No	No reclamation work is required. However, materials especially top soil excavated during the civil works will be used for greenbelt development / plantation.
1.11	Dredging?	No	No dredging is involved.
1.12	Offshore structures?	No	Not Applicable
1.13	Production and manufacturing processes?	Yes	Grain Based Ethanol plant process: <ul style="list-style-type: none"> • Grain Storage Silos, Cleaning, Handling and Milling

			<p>Section</p> <ul style="list-style-type: none"> • Slurry Preparation, Cooking & Liquefaction • Saccharification & Fermentation • Multi-Pressure Distillation • Molecular Sieve Dehydration • Decantation • Integrated Multi-Effect Evaporation • DWGS Dryer Section • Alcohol Daily Receivers & Bulk storage <p><i>Manufacturing process details are described in Pre-Feasibility Report.</i></p>
1.14	Facilities for storage of goods or materials?	Yes	<p>Materials required for process like grains will be stored in silos/Covered Shed. Finished product (Ethanol) will be initially collected in respective daily receivers and then transferred to bulk storage tanks. DDGS will be packed in bags and stored in covered sheds/go downs. Fuel like Biomass (Rice Husk/ paddy straw/ agricultural waste)/coal will be stored in covered sheds only.</p>
1.15	Facilities for treatment or disposal of solid waste or liquid effluents?	Yes	<p><u>Solid Waste</u></p> <ul style="list-style-type: none"> • Ash (30 TPD) generated from the boiler will be used for brick manufacturing. Company will supply ash to nearby brick manufacturers in covered vehicles and will also explore possibilities for in-house brick manufacturing unit. • DDGS (70 TPD) will be utilized as Cattle, poultry and fish feed ingredients. <p><u>Liquid waste</u></p> <ul style="list-style-type: none"> • Grain Slops (920 TPD) will be taken through Centrifuge Decanters for separation of Suspended Solids separated as Wet Cake & will then be treated in Multi Effect Evaporator followed by DWGS dryer to finally obtain DDGS (70 TPD) (Cattle, poultry and fish feed). • Process condensate & other wastewater will be treated in CPU/ETP of Capacity 1000 KLPD and recycled within plant premises.
1.16	Facilities for long term housing of operational workers?	Yes	<p>The operational workers will be employed from nearby area, who may commute daily from their residence for work therefore; no long-term housing will be required.</p>

			Also, nearest city Barauni is 3.8 Km from the project site; employees may also be accommodated there. Transport and other facilities will be provided by the company.
1.17	New road, rail or sea traffic during construction or operation?	Yes	During construction phase, incremental traffic load on nearby NH-122 (<i>Formerly known as NH-28</i>) will be marginal. During operation phase, all Raw materials and finish product transport will be done considering 100 % transportation by road, therefore road traffic will be increased after the proposed project.
1.18	New road, rail, air waterborne or other transport infrastructure including new or altered routes and stations, ports, airports etc?	No	Proposed project is situated near NH-122 (<i>Formerly known as NH-28</i>) (~0.5 km in SW direction) and NH- 31 (~2.0 km in SSE direction). Existing infrastructure will be sufficient for this project, thus, no new road, rail, air waterborne or other transport infrastructure including new or altered routes and stations, ports, airports etc. will be required.
1.19	Closure or diversion of existing transport routes or infrastructure leading to changes in traffic movements?	No	There will be no closure or diversion of existing transport routes or infrastructure leading to changes in traffic movements will be required for proposed project.
1.20	New or diverted transmission lines or pipelines?	No	No new or diverted transmission lines or pipelines are there.
1.21	Impoundment, damming, culverting, realignment or other changes to the hydrology of watercourses or aquifers?	No	There will be no impoundment, damming, culverting, realignment or other changes to the hydrology of watercourses or aquifers.
1.22	Stream crossings?	No	No stream crossing the site.
1.23	Abstraction or transfers of water from ground or surface waters?	Yes	Total water requirement for the Grain based Ethanol Plant will be 2504 KLPD out of which 1756 KLPD will be recycled in plant operations. Hence, the fresh water requirement for the project will be 768 KLPD (748 KLPD Plant + Domestic 20 KLPD) which will be sourced from groundwater.
1.24	Changes in water bodies or the land surface affecting drainage or run-off?	No	Topography of the land is more or less flat which may require little leveling / cutting and filling for construction of the project. No change in the water bodies or the land surface affecting drainage or runoff envisaged.
1.25	Transport of personnel or materials for construction, operation or decommissioning?	Yes	Local people will be employed for construction purpose; no transportation facility will be required for them. The transport arrangements for operational workers will be

			<p>provided for coming from nearby villages / towns from where they can commute to and fro for work.</p> <p>There will be transportation of material and machinery during construction phase by road.</p> <p>During operational phase, transportation of raw materials and finish product will be done by road.</p>
1.26	Long-term dismantling or decommissioning or restoration works?	No	No Long-term dismantling or decommissioning or restoration works envisaged.
1.27	Ongoing activity during decommissioning which could have an impact on the environment?	No	No such impact envisaged.
1.28	Influx of people to an area is either temporarily or permanently?	Yes	Temporary or permanent influx of people will be there as the managerial and supervisory staff will be recruited from different areas. During construction phase almost 150 persons will be required. Total manpower required during the operational phase of the project will be 100 persons. Preference will be given to the nearby villages as per eligibility.
1.29	Introduction of alien species?	No	Introduction of alien species is not envisaged. The plant species will be native and selected in consultation with the Local Forest Department and local people.
1.30	Loss of native species or genetic diversity?	No	No such case is reported from the area so far neither envisaged.
1.31	Any other actions?	No	Not Applicable

2. Use of Natural resources for construction or operation of the Project (such as land, water, materials or energy, especially any resources which are non-renewable or in short supply):

S. No.	Information/checklist confirmation	Yes/ No	Details thereof (with approximate quantities/ rates, wherever possible) with source of information data
2.1	Land especially undeveloped or agricultural land (ha)	Yes	Total land area required for the proposed project is 8.09 ha (20.0 acres); which is already under the possession of the company and is industrial in nature. The land has been allotted to the company by Bihar Industrial Area Development Authority (BIADA). There will not be any change in land use; only intensity will increase due to operations of ethanol plant.
2.2	Water (expected source & competing	Yes	Total water requirement for the Grain based Ethanol Plant

	users) unit: KLPD		will be 2504 KLPD out of which 1756 KLPD will be recycled in plant operations. Hence, the fresh water requirement for the project will be 768 KLPD (748 KLPD Plant + Domestic 20 KLPD) which will be sourced from groundwater.
2.3	Minerals (MT)	No	Not Applicable
2.4	Construction material – stone, aggregates, sand / soil (expected source – MT)	Yes	Construction material as available locally such as sand, reinforcement steel, cement etc. will be used. The quantification of the materials will be done during detailed engineering stage.
2.5	Forests and timber (source – MT)	No	No Forests and timber are required.
2.6	Energy including electricity and fuels (source, competing users) Unit: fuel (MT), energy (MW)	Yes	The total power requirement for the proposed Ethanol Plant will be 3.5 MW, which will be sourced from 3.5 MW Co-Generation Power Plant. D.G. sets of 2 x 500 KVA will be installed for the power backup Fuel for 27 TPH Boiler: Biomass/Rice husk/Coal etc.
2.7	Any other natural resources (Use appropriate standard units)	No	Not Applicable

3. Use, storage, transport, handling or production of substances or materials, which could be harmful to human health or the environment or raise concerns about actual or perceived risks to human health.

S. No.	Information/Checklist confirmation	Yes/ No	Details thereof (with approximate quantities/rates, wherever possible) with source of information data
3.1	Use of substances or materials, which are hazardous (as per MSIHC rules) to human health or the environment (flora, fauna, and water supplies)	Yes	The hazardous chemicals used in the plant are Caustic Soda (Sodium Hydroxide). The hazardous chemicals will be provided with proper storage facilities as per MSIHC rules to avoid any harm to environment or human health.
3.2	Changes in occurrence of disease or affect disease vectors (e.g. insect or water borne diseases)	No	The Ethanol Plant will be based on "Zero Liquid Discharge". Therefore; there will be no changes in occurrence of disease or affect disease vectors.
3.3	Affect the welfare of people e.g. by changing living conditions?	Yes	Positive impact is envisaged at local as well as regional level in the project area viz., generation of direct - indirect employment opportunities, improved local Infrastructure facilities, Increased revenue to the State & Central exchequer by participation in EBP Programme. In addition, various rural development initiatives for the upliftment of the nearby communities will be undertaken under socio-economic developmental activities.

3.4	Vulnerable groups of people who could be affected by the project e.g. hospital patients, children, the elderly etc.,	Yes	There are many schools, hospitals, dispensaries, and hotels etc. in the study area, which have the vulnerable group of people who could be affected by the project if proper mitigation measures are not implemented. The company will take all precautionary measures to ensure there are no negative impacts because of the proposed project and also take measures to control air, water and noise pollution.
3.5	Any other causes	No	Not Applicable

4. Production of solid wastes during construction or operation or decommissioning (MT/month)

S. No.	Information/Checklist confirmation	Yes/ No	Details thereof (with approximate quantities/rates, wherever possible) with source of information data
4.1	Spoil, overburden or mine wastes	No	The scraps and minor construction waste will be sold to dealers and reused for leveling wherever necessary.
4.2	Municipal waste (domestic and or commercial wastes)	Yes	Municipal solid waste generated from Plant canteen will be disposed after segregating into bio-degradable and non-degradable waste. Bio-degradable waste will be composted and non-degradable wastes will be disposed off suitably.
4.3	Hazardous wastes (as per Hazardous Waste Management Rules)	Yes	Used or Spent oil to the tune of 0.5 KL/annum (Cat. 5.1), Contaminated cotton rags or other cleaning materials (Cat 33.2) Empty barrels will be generated as per Schedule I of Hazardous and Other Wastes (Management and Transboundary Movement) Rules, 2016.
4.4	Other industrial process wastes	Yes	Ash (30 TPD) generated from the boiler will be used for brick manufacturing. Company will supply ash to nearby brick manufacturers in covered vehicles and will also explore possibilities for in-house brick manufacturing unit.
4.5	Surplus product	No	No surplus product envisaged.
4.6	Sewage sludge or other sludge from effluent treatment	Yes	Sludge will be dried and used as manure.
4.7	Construction or demolition wastes	Yes	Construction waste like soil, brick bits will be utilized in levelling of land and road making. No demolition waste will be generated.
4.8	Redundant machinery or equipment	No	There will be no redundant machinery or equipment.
4.9	Contaminated soils or other materials	No	There will not be any contaminated soils or other materials.
4.10	Agricultural wastes	No	There will not be any agricultural wastes.

4.11	Other solid wastes	Yes	DDGS - Dried Distillers Grains Soluble (By product- 70 TPD) will be sold as by-products for Cattle/Poultry/Fish feed.
------	--------------------	------------	---

5. Release of pollutants or any hazardous, toxic or noxious substances to air (Kg/hr)

S. No.	Information/Checklist confirmation	Yes/ No	Details thereof (with approximate quantities/rates, wherever possible) with source of information data
5.1	Emissions from combustion of fossil fuels from stationary or mobile sources	Yes	The major pollutants of the plant will be particulate matter, SO ₂ & NO _x from the proposed 27 TPH boiler. ESP with adequate stack height (45 m) will be installed to maintain the emission levels within prescribed standards.
5.2	Emissions from production processes	Yes	CO ₂ generated (114 TPD) during fermentation process will be collected and sold to vendors.
5.3	Emissions from materials handling including storage or transport	Yes	Fugitive emissions will be generated during transport and storage of material. Company will have provisions of material transfer in closed loop and covered manner so negligible emissions are envisaged. Covered storage facilities will be provided for raw material & finished products. Road sweeping machines will be used for cleaning of paved roads and proper house-keeping will be maintained to control fugitive dust emissions. All vehicles will be PUC certified.
5.4	Emissions from construction activities including plant and equipment	Yes	Fugitive dust emissions are likely to be generated from construction activities and vehicular movements. These emissions will be temporary and will be controlled by water spraying and regular sweeping of internal roads.
5.5	Dust or odours from handling of materials including construction materials, sewage and waste.	Yes	During construction, there will be minor generation of dust which will be controlled by water spaying and road sweeping regularly. Odor problems will be properly controlled at source by good operational practices, including physical and management control measures.
5.6	Emissions from incineration of waste	No	There will be no incineration of waste.
5.7	Emissions from burning of waste in open air (e.g. slash materials, construction debris)	No	There will be no burning of waste in open air.
5.8	Emissions from any other sources	No	There will be no emissions from any other sources.

6. Generation of Noise and Vibration, and Emissions of Light and Heat:

S. No.	Information/Checklist confirmation	Yes/ No	Details thereof (with approximate quantities/rates, wherever possible) with source of information data with source of information data
6.1	From operation of equipment e.g. engines, ventilation plant, crushers	Yes	In the Ethanol plant, noise will emanate from operation of equipment; which will be kept below the prescribed limit by CPCB. Proper noise abatement measures will be taken and persons working close to machine and machine operators will be provided with personal protective equipment viz. Ear plugs / Ear muffs/defenders etc. for further protection. Vibrations due to any operation are ruled out. D.G sets (Whenever required for back up) will be covered with acoustic enclosures to control noise level. Noise level will be within permissible limit.
6.2	From industrial or similar processes	Yes	Noise will be generated due to the running of the machinery {60 to 70 Leq. (A)} will be kept below the prescribed limit by CPCB. Proper mitigation measures will be taken for the reduction of noise levels viz. acoustic enclosures etc. The workers will be provided with PPE; personal protective equipment.
6.3	From construction or demolition	Yes	Noise generated from the construction activities such as drills, hammering, cement mixing, heavy vehicle transportation, welding etc. {50 to 60 Leq. (A)} will be maintained within the prescribed noise standards.
6.4	From blasting or piling	No	There will be no blasting. Slight noise during piling activities will be addressed by providing PPEs and covering.
6.5	From construction or operational traffic	Yes	There will be some noise {50 to 55 Leq. (A)} due to movement of machine/vehicle but the same will be maintained within the prescribed limit.
6.6	From lighting or cooling systems	No	No noise will be generated from lighting or cooling systems
6.7	From any other sources	No	There are no other sources of noise generation.

7. Risks of contamination of land or water from releases of pollutants into the ground or into sewers, surface waters, groundwater, coastal waters or the sea:

S. No.	Information/Checklist confirmation	Yes/ No	Details thereof (with approximate quantities/rates, wherever possible) with source of information data
7.1	From handling, storage, use or spillage of hazardous materials.	No	Permission will be obtained from The Petroleum and Explosives Safety Organization (PESO) for proper storage of ethanol. Used oil to the tune of 0.5 KL/annum for lubrication will be handled in closed containers and stored at designated areas as per Hazardous and Other Wastes (Management and Transboundary Movement) Rules, 2016 and will be sold to CPCB authorized recycler. Also, care will be taken during its use for lubrication of external part of equipment, so that nothing falls on ground, which will contaminate the soil. Equipment will be kept well maintained, so that they may remain leakage free.
7.2	From discharge of sewage or other effluents to water or the land (expected mode and place of discharge)	No	The ethanol plant will be based on the concept of "Zero Liquid Discharge" hence no sewage or other effluent will be discharged outside the plant premises.
7.3	By deposition of pollutants emitted to air into the land or into water	Yes	There is likely hood of increase of air emissions. But proper mitigating measures will be adopted to reduce the effect such as installation of pollution control equipment, greenbelt development, dust suppression by regular water sprinkling etc., However, periodical monitoring and continuous online Emission monitoring will be done and results will be analyzed. In case of any exigencies, corrective measures will be taken.
7.4	From any other sources	No	Not Applicable
7.5	Is there a risk of long term build up of pollutants in the environment from these sources?	No	No long-term buildup of pollutants in the environment is envisaged, the emission levels will be maintained well within the prescribed standards and continuous online stack (CEMS) monitoring will be done so that timely mitigation measures can be undertaken.

8. Risk of accidents during construction or operation of the Project, which could affect human health or the environment

S. No.	Information/Checklist confirmation	Yes/ No	Details thereof (with approximate quantities/rates, wherever possible) with source of information data
8.1	From explosions, spillages, fires etc. from storage, handling, use or production of hazardous substances	Yes	The hazardous materials will be stored in a proper storage facility designed with protective measures to avoid risks due to spillages and leakages. Proper handling and storage practices will eliminate risk of accidents. However; in an emergency, fire-fighting equipment will be provided near all risk prone areas. Workers will be properly trained to use fire-fighting system to quench the fire at source itself.
8.2	From any other causes	No	Not Applicable
8.3	Could the project be affected by natural disasters causing environmental damage (e.g. floods, earthquakes, landslides, cloudburst etc)?	No	No such case has been reported in the area and chances are minimal. However, we will be having Emergency and Contingency plans in place.

9. Factors which should be considered (such as consequential development) which could lead to environmental effects or the potential for cumulative impacts with other existing or planned activities in the locality

S. No.	Information/Checklist confirmation	Yes/ No	Details thereof (with approximate quantities/rates, wherever possible) with source of information data
9.1	Lead to development of supporting utilities, ancillary development or development stimulated by the project which could have impact on the environment e.g.: <ul style="list-style-type: none"> • Supporting infrastructure (roads, power supply, waste or waste water treatment, etc.) • housing development • extractive industries • supply industries • other 	Yes	Proposed project will result in considerable growth of the surrounding areas. Some of the direct & indirect benefits are as follows: <ul style="list-style-type: none"> • By generating direct and indirect employment opportunities in the region including ancillary development. • Promoting Education • Health and Family Welfare • Social Welfare Services • Infrastructure development • Sustainable livelihood (women empowerment) Overall growth of the surrounding area in terms of socio-economic status and standard of living.
9.2	Lead to after-use of the site, which could have an impact on the environment	No	Negligible impact is envisaged on air, noise and aesthetic parameters due to the proposed project.

Proposed 150 KLPD Grain based Ethanol Plant along with 3.5 MW Cogeneration Power Plant At Plot No. 4, Growth Centre Begusarai Industrial Area, Village Asurari, Tehsil Barauni, Begusarai, Bihar	
Form-1 / Appendix-I	

9.3	Set a precedent for later developments	Yes	This project will have positive effect on the living standards of local people in terms of employment, infrastructure and overall development of the area.
9.4	Have cumulative effects due to proximity to other existing or planned projects with similar effects.	No	Positive impact on overall development of the area is envisaged in terms of improvement in local Infrastructure & economic well-being of the people around.

(III) Environmental Sensitivity

S. No.	Areas	Name/ Identity	Aerial distance (within 15 km.) Proposed project location boundary
1	Areas protected under international conventions, national or local legislation for their ecological, landscape, cultural or other related value.	No	As per the details available on Survey of India Toposheet there is no area within 15 km radius of the proposed project falling or protected under international conventions, national or local legislation for their ecological, landscape, cultural or other related value.
2	Areas which are important or sensitive for ecological reasons-Wetlands, watercourses or other water bodies, coastal zone, spheres, mountains, forests	Yes	<u>Water bodies:</u> <ul style="list-style-type: none"> • Balan Nadi (~ 3.5 km in North direction) • Baya Nadi (~ 5.0 km in WSW direction) • Ganga River (~ 6.5 km in SW direction) • Bainti Nadi (~ 12 km in North direction) • Burhi Gandak River (~ 12 km in NE direction)
3	Areas used by protected, important or sensitive species of flora or fauna for breeding, nesting, foraging, resting, over wintering, migration	No	As per the Secondary Literature survey i.e. Journal, no endangered / Endemic or sensitive species of the Flora & fauna is reported in the study area.
4	Inland, coastal, marine or underground waters	No	Not applicable
5	State, National boundaries	No	Not applicable
6	Routes or facilities used by the public for access to recreation or other tourist, pilgrim areas	Yes	<ul style="list-style-type: none"> • NH-122 (Formerly known as NH-28) (~0.5 km in SW direction) • NH- 31 (~2.0 km in SSE direction) • Barauni Junction Railway Station (~4.0 km in WSW direction)
7	Defense installations	No	Not applicable
8	Densely populated or built-up area	Yes	<ul style="list-style-type: none"> • Barauni (~3.8 km in West direction)

Proposed 150 KLPD Grain based Ethanol Plant along with 3.5 MW Cogeneration Power Plant At Plot No. 4, Growth Centre Begusarai Industrial Area, Village Asurari, Tehsil Barauni, Begusarai, Bihar	
Form-1 / Appendix-I	

			<ul style="list-style-type: none"> Begusarai (~9.0 km in ESE direction)
9	Areas occupied by sensitive man-made land uses (<i>hospitals, schools, places of worship, community facilities</i>)	Yes	There are schools, Colleges, Hospitals, Markets, Railway station, places of worship within 15 km radius of the project site.
10	Areas containing important, high quality or scarce resources (<i>ground water resources, surface resources, forestry, agriculture, fisheries, tourism, minerals</i>)	None	The area falls under Safe category as per the CGWB categorization, 2017. The surface water resources have been mentioned in Point No. 2. Agricultural land is available in the study area.
11	Areas already subjected to pollution or environmental damage. (<i>Those where existing legal environmental standards are exceeded</i>)	None	There is no area; which is already subjected to pollution or environmental damage as per monitoring done by CPCB in 2018 within 15 km radius of the project site.
12	Areas susceptible to natural hazard which could cause the project to present environmental problems (<i>earthquakes, subsidence, landslides, erosion, flooding or extreme or adverse climatic conditions</i>)	Yes	The project site falls in Seismic Zone IV as per IS: 1893 (Part-I): 2002.

(IV) Proposed Terms of Reference

New Way Homes Private Limited is proposing 150 KLPD Grain based Ethanol Plant along with 3.5 MW Co-generation power plant at Plot No. 4, Growth Centre Begusarai Industrial Area, Village Asurari, Tehsil Barauni, Begusarai, Bihar in a total project area of 8.09 ha (20.0 acres). The land has been allotted to the company by Bihar Industrial Area Development Authority (BIADA).

The Government of India approved the National Policy on Bio-fuels in 04th June 2018 stipulating Ethanol Blended with Petrol (EBP) Programme as its main component, offering indigenous and non-polluting renewable energy source and successful implementation of the programme would not only result in substantial reduction in air pollution but also saving of precious foreign exchange through import substitutions. This policy has laid out indicative targets of achieving 20% blending of ethanol in petrol in the whole country by 2030. The government of India has advanced the target for 20% ethanol blending in petrol (also called E20) from 2030 to 2025.

Accordingly Ministry of Environment, Forest and Climate Change to give a further boost to the Ethanol Blending Program, Grain based distilleries, having Zero Liquid Discharge (ZLD) and setup to produce only ethanol for the purposes of Ethanol Blending Program of the Government, and keeping in view overall environmental, social and economic benefits in production of ethanol from such distilleries including reduction in Green House Gas emissions in comparison to conventional fossil-fuel, less water and air pollution, potential boost to agricultural economy and reduced dependence on imported fossil fuel by equivalent amount, the Central Government deems it necessary to give a special dispensation as regards

granting of Environmental Clearances (EC) to such category of projects [Manufacturing of ethanol by Grain Based distilleries with Zero Liquid Discharge, to be used for Ethanol Blended Petrol Programme of the Government], subject to certain conditions.

According to latest MOEFCC notification S. No. 2339(E) dated 16th June, 2021, "*Grain based distilleries with Zero Liquid Discharge producing ethanol; solely to be used for Ethanol Blended Petrol Programme of the Government of India shall be considered under B2 Category*" with condition that the project proponent shall file a notarized affidavit that ethanol produced from proposed project shall be used completely for EBP Programme.

The company is submitting the notarized affidavit (self-declaration as mentioned in the Notification dated 16th June, 2021) stating that the new 150 KLPD Grain based Ethanol Plant along with 3.5 MW Cogeneration Power Plant will be completely utilized for production of ethanol only so as to participate in Ethanol blending Programme (EBP) of Government of India (Gol).

In view of the above submissions, we humbly request you to kindly consider our proposal for grant of Environmental Clearance under "B2" Category.

(V) Undertaking

UNDERTAKING

"I hereby give undertaking that the data and information given in the application and enclosures are true to the best of my knowledge and belief and I am aware that if any part of the data and information submitted is found to be false or misleading at any stage, the project will be rejected and clearance given if any to the project will be revoked at our risk and cost.

Date: 29.12.2021

Place: New Delhi

Signature of the applicant
New Way Homes Pvt. Ltd.

Sanjay Kumar Singh

Director

M/s New Way Homes Private Limited

Note:

1. The projects involving clearance under Coastal Regulation Zone Notification, 1991 will submit with the application a C.R.Z. map duly demarcated by one of the authorized agencies, showing the project activities, w.r.t. C.R.Z. (at the stage of ToR) and the recommendations of the State Coastal Zone Management Authority (at the stage of EC). Simultaneous action will also be taken to obtain the requisite clearance under the provisions of the C.R.Z. Notification, 1991 for the activities to be located in the CRZ.
2. The projects to be located within 10 km of the National Parks, Sanctuaries, Biosphere Reserves, Migratory Corridors of Wild Animals, the project proponent will submit the map duly authenticated by Chief Wildlife Warden showing these features vis-à-vis the project location and the recommendations or comments of the Chief Wildlife Warden thereon (at the stage of EC).
3. All correspondence with the Ministry of Environment & Forests including submission of application for ToR/Environmental Clearance, subsequent clarifications, as may be required from time to time, participation in the EAC Meeting on behalf of the project proponent will be made by the authorized signatory only. The authorized signatory should also submit a document in support of his claim of being an authorized signatory for the specific project.



**Physical land possession order
by Bihar Industrial Area
Development Authority
(BIADA)**



Bihar Industrial Area Development Authority

Regional Office-Bela Darbhanga

Head Office-First Floor, Udyog Bhawan, East Gandhi Maidan, Patna-4

Website www.biadabihar.in Email- ed.dbg-bih@gov.in, Phone/Fax: 0612-247505, fax-06272-247045

PHYSICAL POSSESSION ORDER

Name of the unit	New Way Homes Pvt. Ltd.
Address of the unit	Director-Sri Sanjay Kumar Singh, At-GF-II Ground Flour, Prakash Deep Building, 7 Tolstoy Marg. New Delhi-110001.
Allotment order No.	1586/D, dated:-09.06.2021.
Office Order No	466, Date-12.08.2021
Area Handed over	1306800 Sq.ft. (30.00 Acre)
Industrial Plot No	4

Area Handed Over

Area Taken Over

14/09/2021

Area In-Charge

G C Begusarai

Memo No. 269...

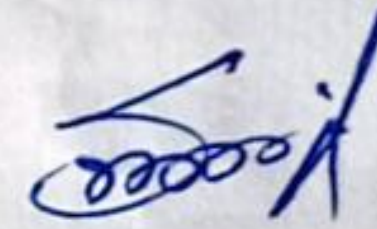

Dated. 14/09/21

- ✓ Copy forwarded **New Way Homes Pvt. Ltd.** Director-Sri Sanjay Kumar Singh, At-GF-II Ground Flour, Prakash Deep Building, 7 Tolstoy Marg. New Delhi-110001. with a copy of original Map for information and necessary action.
- Copy forwarded to Executive Director, BIADA, Darbhanga with a copy of original Map.
- Copy forwarded Account officer, BIADA, Darbhanga

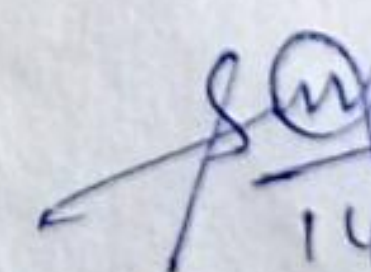
14/09/21

Area In-charge

G C Begusarai

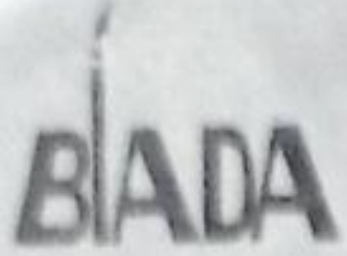

Bihar Industrial Area Development Authority

Regional Office-Bela Darbhanga

Head Office-First Floor, Udyog Bhawan, East Gandhi Maidan, Patna-4

Website www.biadabihar.in Email- cd.dbg-bih@gov.in, Phone/Fax: 0612-247505, fax-06272-247045

INDEX PLAN SHOWS THE LAND ALLOTTED TO NEW WAY HOMES PVT.LTD.DIRECTOR-SRI SANJAY KUMAR SINGH,AT-GF-II GROUND FLOUR,PRAKASH DEEP BUILDING 7 TOLSTOY MARG,NEW DELHI-110001.IN GROWTH CENTER BEGUSARAI, ALLOTTED PLOT NO-4,AREA-30.00 ACRE.(1306800 SQFT). VIDE MEMO NO 466 ,DATED-12.08.2021,

Industrial Area	Industrial Plot No.	Survey Plot No	Khata No.	Area (in Acre.)	Village	Thana No.	P.S.	Pargana	District	Sub Registry
G C Begusarai	4	Attached Annexure A	Attached Annexure A	30.00	Ashurari	472	Barani	Malki	Begusarai	Begusarai

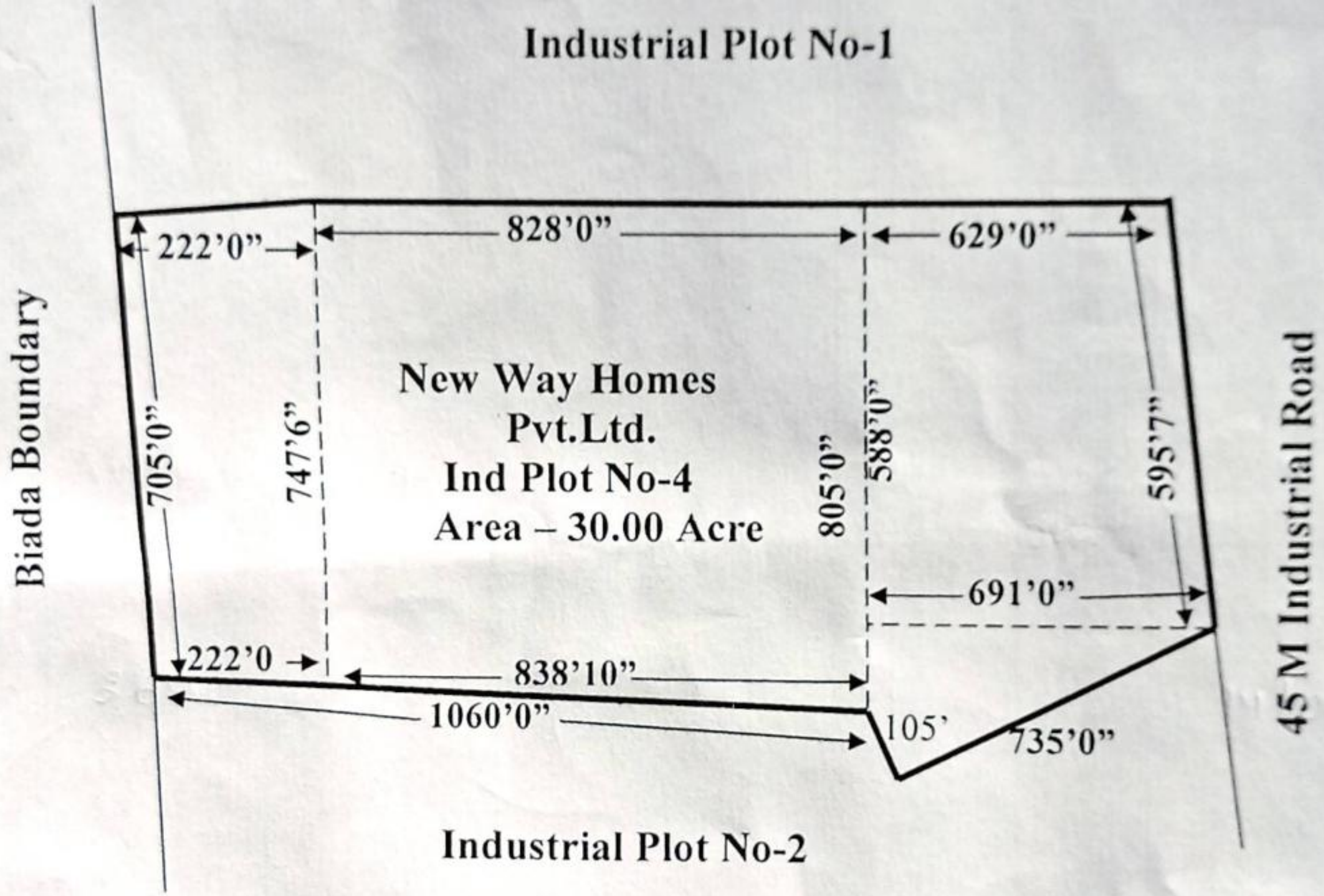

Reference

Allotted Plot

BOUNDARY

- NORTH : Industrial Plot No-1
- SOUTH : Industrial Plot No-2
- EAST : 45 M Industrial Road
- WEST : Biada Boundary

जाति
14-9-2021

(Vinod Ray)
Amin,
BIADA, RO Darbhanga

New Way Homes Pvt.Ltd.Director-Sri Sanjay Kumar Singh,At-Gf-li Ground Flour,Prakash Deep Building 7 Tolstoy Marg,New Delhi-110001

Signature
14/09/21

Area In-Charge,
G C Begusarai

Bihar Industrial Area Development Authority

Regional Office-Bela Darbhanga

Head Office-First Floor, Udyog Bhawan, East Gandhi Maidan, Patna-4

Website www.biadabihar.in Email- ed.dbg-bih@gov.in, Phone/Fax: 0612-247505, fax-06272-247045

ANNEXURE-A

Village	Thana No	Thana	Pargana	Anchal	Area (in acre)	Khata	Survey Plot No	Khata No	Survey Plot No
Asurari	472	Teghra	Malki	Barauni	30.00		336(P)		433
							337(P)		434
							373(P)		435
							374		438(P)
							375		439(P)
						44	376		440(P)
							377		686(P)
							378(P)	246	687(P)
							379(P)		689(P)
							397(P)	159	690
						330	398		691
							399		692
						67	400		693
						41	401	184	694
						330	402	184	695
							403	184	696
							404	184	697
							405		698
							406		699
						44	407	184	700
							408		701
							409		702
							410		703
							411		704(P)
							412		706(P)
							413(P)		723(P)
							414(P)		952(P)
						35	426(P)		953(P)
							427		954(P)
							428(P)	216	955(P)
						50	429		958(P)
							430		959(P)
	431		962(P)						
	432								

14-9-2021
अधीन

[Handwritten Signature]

14/09/21