

K. K. MINES AND MINERALS

**SURVEY NO. 451, MOMIDI VILLAGE, CHILLAKUR MANDAL,
SPSR NELLORE DISTRICT, ANDHRA PRADESH**

FORM I

SUBMITTED BY

**M/s. K. K. Mines and Minerals
Sri Katamreddy Ravindra Reddy
D. No. 27-4-242, Flat No. 404,
Sai Ashraya Homes, Ramji Nagar,
SPSR Nellore - 524002
Mobile No. +91 99893 67070**

STUDIES AND DOCUMENTATION BY

**TEAM Labs and Consultants
B-115, 116,117 & 509, Annapurna Block,
Aditya Enclave, Ameerpet,
Hyderabad-500 038
Phone: 040-23748 555/616,
Tele fax: 040-23748666
Email: teamlabs@gmail.com**

**SUBMITTED TO
STATE LEVEL ENVIRONMENTAL IMPACT ASSESSMENT AUTHORITY,
ANDHRA PRADESH,
GOVERNMENT OF INDIA**

APPENDIX I
(See paragraph – 6)
FORM 1

(I) Basic Information

S. No	Item	Details
1	Name of the Project/s	M/s. K. K. Mines and Minerals – Silica Sand Mine
2	S. No in the Schedule	1(a)
3	Proposed capacity/area/length/tonnage to be handled/command area/lease area/number of wells to be drilled	Quarry lease area is 7.867 ha (Manual opencast method for Silica Sand production of 52290 TPA).
	Capital cost proposed for project	Rs. 55 Lakhs.
4	New/Expansion/Modernization	New mine
5	Existing Capacity/Area etc.	
6	Category of Project i.e 'A' or 'B'	B2
7	Does it attract the general condition? If yes, please specify	No
8	Does it attract the Specific condition? If yes, please specify.	No
9	Location	
	Plot/Survey/Khasra No.	Survey No. 451, Momidi Village, Chillakur Mandal, SPSR Nellore District, Andhra Pradesh
	Village	
	Tehsil	
	District	
	State	
10	Nearest railway station/airport along with distance in kms.	Railway Station: Gudur – 23 Km – SW
11	Nearest Town, City, District Headquarters along with distance in kms.	Town: Gudur – 23 Km – SW District Head quarters: Nellore-28 km -NW
12	Village Panchayats, Zilla Parishad, Municipal Corporation, Local body (complete postal address with telephone nos. to be given)	Village Panchayat: Momidi Zilla Parishad: SPSR Nellore
13	Name of the Applicant	M/s. K. K. Mines and Minerals
14	Registered Address	M/s. K. K. Mines and Minerals Sri Katamreddy Ravindra Reddy D. No. 27-4-242, Flat No. 404, Sai Ashraya Homes, Ramji Nagar, SPSR Nellore – 524002 Mobile No. +91 99893 67070
15	Address for Correspondence:	
	Name	Sri Katamreddy Ravindra Reddy
	Designation(Owner/Partner/CEO)	Proprietor
	Address	D. No. 27-4-242, Flat No. 404,

S. No	Item	Details
		Sai Ashraya Homes, Ramji Nagar, SPSR Nellore – 524002
	Pin Code	524002
	E-mail	
	Telephone Number	Mobile No. +91 99893 67070
	Fax No.	Fax: 040 - 23748555
16	Details of alternative Sites examined, if any. Location of these sites should be shown on a topo sheet.	Village-District-State – -NA – Site specific project i.e. mining.
17	Interlinked Projects	-NA-
18	Whether separate application of interlinked project has been submitted?	No
19	If yes, date of submission	-
20	If no, reason	-
21	Whether the proposal involves approval/clearance under: if yes, details of the same and their status to be given. (a) The Forest (Conservation) Act, 1980? (b) The Wildlife (Protection) Act, 1972? (c) The C.R.Z Notification, 1991?	No.
22	Whether there is any Government Order/Policy relevant/relating to the site?	Yes – In principle grant of quarry lease notice was issued by Department of Mines and Geology, Ibrahimpatnam vide Notice no. 7079/R3-1/2018 dated 22.10.2018 for a period of 20 years. Mining Plan was approved by the Deputy Director of Mines and Geology, Government of Andhra Pradesh vide Letter no. 4861/MP/SS/NLR/2018 dated 23.11.2018.
23	Forest land involved (hectares)	Nil
24	Whether there is any location pending against the project and /or land in which the project is propose to be set up? (a) Name of the Court, (b) Case No, (c) Orders/directions of the Court, if any and its relevance with the proposed project.	No, There is no case pending against the project location.

(II) Activity**1. Construction, operation or decommissioning of the Project involving actions, which will cause physical changes in the locality (topography, land use, changes in water bodies, etc.)**

S. No.	Information/Checklist confirmation	Yes/No	Details thereof (with approximate quantities /rates, wherever possible) with source of information data
1.1	Permanent or temporary change in land use, land cover or topography including increase in intensity of land use (with respect to local land use plan)	NO	The quarry lease area is 7.867 ha. The quarry lease area is an undulated sand bearing terrain with very less number of bushes and shrubs. Proposed method of mining is Manual opencast method.
1.2	Clearance of existing land, vegetation and buildings?	NO	
1.3	Creation of new land uses?	NO	
1.4	Pre-construction investigations e.g. bore houses, soil testing?	YES	Survey completed, based on the soil quality mine office cum rest shelter will be constructed temporarily.
1.5	Construction works?	YES	Construction activity involves infrastructure only with temporary structures.
1.6	Demolition works?	NO	
1.7	Temporary sites used for construction works or housing of construction workers?	NO	Local villagers shall be employed, temporary rest shelter will be provided.
1.8	Above ground buildings, structures or earthworks including linear structures, cut and fill or excavations	YES	Above ground building for the mine office only as temporary. No major excavation activity involved.
1.9	Underground works including mining or tunneling?	NO	The present method of mining is Manual opencast method for Silica Sand.
1.10	Reclamation works?	NO	No reclamation is proposed in the ensuing Plan period. The area is plain terrain which can be used into any services. It can be used for casuarinas plantation at the end of the mining activity.
1.11	Dredging?	NO	
1.12	Offshore structures?	NO	
1.13	Production and manufacturing processes?	YES	Manual opencast method mining proposed to extract Silica Sand of 52290 TPA. (Annexure-I)
1.14	Facilities for storage of goods or materials?	YES	Mineral stock yard is proposed.

S. No.	Information/Checklist confirmation	Yes/No	Details thereof (with approximate quantities /rates, wherever possible) with source of information data
1.15	Facilities for treatment or disposal of solid waste or liquid effluents?	YES	No waste is generated in this mine area, only Handling loss will be occurred. Hence no proposed dumps. Liquid waste i.e. effluent from the domestic source shall be sent to septic tank followed by soak pit. (Annexure-III)
1.16	Facilities for long term housing of operational workers?	NO	Local villagers shall be employed on daily basis.
1.17	New road, rail or sea traffic during construction or operation?	NO	Manual opencast mining with limited trucks for transportation of mineral. The number of truck trips will be 10 per day.
1.18	New road, rail, air waterborne or other transport infrastructure including new or altered routes and stations, ports, airports etc?	NO	
1.19	Closure or diversion of existing transport routes or infrastructure leading to changes in traffic movements?	NO	
1.20	New or diverted transmission lines or pipelines?	NO	
1.21	Impoundment, damming, culverting, realignment or other changes to the hydrology of watercourses or aquifers?	NO	The proposed method of mining is Manual opencast.
1.22	Stream crossings?	NO	
1.23	Abstraction or transfers of water form ground or surface waters?	NO	Water shall be drawn from local villages for the purpose of domestic and water sprinkling purpose.
1.24	Changes in water bodies or the land surface affecting drainage or run-off?	NO	
1.25	Transport of personnel or materials for construction, operation or decommissioning?	YES	Local villagers shall be employed. Silica Sand is sent away from the site, the numbers of trips will be 10 per day.
1.26	Long-term dismantling or decommissioning or restoration works?	NO	
1.27	Ongoing activity during	NO	

S. No.	Information/Checklist confirmation	Yes/No	Details thereof (with approximate quantities /rates, wherever possible) with source of information data
	decommissioning which could have an impact on the environment?		
1.28	Influx of people to an area in either temporarily or permanently?	NO	
1.29	Introduction of alien species?	NO	
1.30	Loss of native species or genetic diversity?	NO	
1.31	Any other actions?	NO	

2. Use of Natural resources for construction or operation of the Project (such as land, water, materials or energy, especially any resources which are non-renewable or in short supply):

S. No.	Information/checklist Confirmation	Yes/No	Details thereof (with approximate quantities /rates, wherever possible) with source of information data
2.1	Land especially undeveloped or agricultural land (ha)	NO	The proposed quarry lease area of 7.867 ha and used for mining purpose
2.2	Water (expected source & competing users) unit: KLD	YES	4.3 KLD, from nearby village through tankers. (Annexure-II) .
2.3	Minerals (MT)	NO	
2.4	Construction material– stone, aggregates, sand/soil(expected source - MT)	NA	
2.5	Forests and timber (source – MT)	NO	
2.6	Energy including electricity and fuels (source, competing users) Unit: fuel (MT), energy (MW)	YES	Proposed method of mining is Manual opencast, power required for office maintenance shall be drawn from nearby village.
2.7	Any other natural resources (use appropriate standard units)	NO	

3. Use, storage, transport handling or production of substances or materials, which could be harmful to human health or the environment or raise concerns about actual or perceived risks to human health.

S. No.	Information/ Checklist confirmation	Yes/No	Details thereof (with approximate quantities/rates, wherever possible) with source of information data
3.1	Use of substances or materials, which are hazardous (as per MSIHC rules) to human health or the environment (flora, fauna, and water supplies)	NO	There are no Hazardous substances or materials to human health or the environment. It is a Silica Sand quarry and it is a mineral. There is no requirement of drilling and blasting.
3.2	Changes in occurrence of disease or affect disease vectors (e.g. insect or water borne diseases)	NO	It is a Manual opencast Silica Sand quarry and it is a mineral.
3.3	Affect the welfare of people e.g. by changing living conditions?	YES	The proposed project shall enhance the prospects of employment. Recruitment of the unskilled and semiskilled workers for the proposed project will be from the nearby villages.
3.4	Vulnerable groups of people who could be affected by the project e.g. hospital patients, children, the elderly etc.,	NO	The nearest village is Yeruru located at a distance of 2.0 km from the QL area in NW direction. The project shall not have any significant impact on vulnerable groups of people.
3.5	Any other causes	NO	

4. Production of solid wastes during construction or operation or decommissioning (MT/month)

S. No.	Information/Checklist confirmation	Yes/No	Details thereof (with approximate quantities/rates, wherever possible) with source of information data
4.1	Soil, overburden or mine wastes	YES	No waste material is generated.
4.2	Municipal waste (domestic and or commercial wastes)	NO	
4.3	Hazardous wastes (as per Hazardous Waste Management Rules)	NO	
4.4	Other industrial process wastes	NO	
4.5	Surplus product	NO	
4.6	Sewage sludge or other sludge from effluent treatment	NO	
4.7	Construction or demolition wastes	NO	
4.8	Redundant machinery or equipment	NO	
4.9	Contaminated soils or other materials	NO	
4.10	Agricultural wastes	NO	
4.11	Other solid wastes	NO	

5. Release of pollutants or any hazardous, toxic or noxious substances to air (Kg/hr)

S. No.	Information/Checklist confirmation	Yes/No	Details thereof (with approximate quantities/rates, wherever possible) with source of information data
5.1	Emissions from combustion of fossil fuels from stationary or mobile sources	NO	
5.2	Emissions from production processes	NO	
5.3	Emissions from materials handling including storage or transport	YES	Dust may rise during mining, transportation of mineral. The dust emissions shall be mitigated by water spraying.
5.4	Emissions from construction activities including plant and equipment	NO	
5.5	Dust or odours from handling of materials including construction materials, sewage and waste	YES	Dust may rise during mining, transportation of mineral. The dust emissions shall be mitigated by water spraying.
5.6	Emissions from incineration of waste	NO	
5.7	Emissions from burning of waste in open air (e.g. slash materials, construction debris)	NO	
5.8	Emissions from any other sources	NO	

6. Generation of Noise and Vibration, and Emissions of Light and Heat:

S. No.	Information/Checklist confirmation	Yes/No	Details thereof (with approximate quantities/rates, wherever possible) with source of information data with source of information data
6.1	From operation of equipment e.g. engines, ventilation plant, crushers	YES	Noise is anticipated during mining activity from transport vehicles.
6.2	From industrial or similar processes	NO	
6.3	From construction or demolition	NO	
6.4	From blasting or piling	No	There is no drilling and blasting
6.5	From construction or operational traffic	NO	The increased traffic shall not have any significant impact. The number of trips will be 10 per day.
6.6	From lighting or cooling systems	NO	
6.7	From any other sources	NO	

7. Risks of contamination of land or water from releases of pollutants into the ground or into sewers, surface waters, groundwater, coastal waters or the sea:

S. No.	Information/Checklist confirmation	Yes/No	Details thereof (with approximate quantities/rates, wherever possible) with source of information data
7.1	From handling, storage, use or spillage of hazardous materials	NO	The material excavated is Silica Sand and is Non-Hazardous.
7.2	From discharge of sewage or other effluents to water or the land (expected mode and place of discharge)	NO	Septic Tank followed by soak pit shall be provided for temporary toilets.
7.3	By deposition of pollutants emitted to air into the land or into water	NO	
7.4	From any other sources	NO	
7.5	Is there a risk of long term build up of pollutants in the environment from these sources?	NO	

8. Risk of accidents during construction or operation of the Project, which could affect human health or the environment

S. No.	Information/Checklist confirmation	Yes/No	Details thereof (with approximate quantities/rates, wherever possible) with source of information data
8.1	From explosions, spillages, fires etc from storage, handling, use or production of hazardous substances	NO	
8.2	From any other causes	NO	
8.3	Could the project be affected by natural disasters causing Environmental damage (e.g. floods, earthquakes, landslides, Cloudburst etc)?	NO	

9. Factors which should be considered (such as consequential development) which could lead to environmental effects or the potential for cumulative impacts with other existing or planned activities in the locality

S. No.	Information/Checklist confirmation	Yes/No	Details thereof (with approximate quantities/rates, wherever possible) with source of information data
9.1	<p>Lead to development of supporting facilities, ancillary development or development stimulated by the project which could have impact on the environment e.g.:</p> <ul style="list-style-type: none"> •Supporting infrastructure (roads, power supply, waste or waste water treatment, etc.) •Housing development •Extractive industries • Supply industries • Other 	YES	The proposed project shall enhance the prospects of employment. Recruitment for the unskilled and semiskilled workers for the proposed project will be from the nearby villages.
9.2	Lead to after-use of the site, which could have an impact on the environment	NO	
9.3	Set a precedent for later developments	NO	
9.4	Have cumulative effects due to proximity to other existing or planned projects with similar effects	NO	

(III) Environmental Sensitivity

S.No.	Areas	Name/ Identity	Aerial distance (within 15 km.) Proposed project location boundary
1	Areas protected under international conventions, national or local legislation for their ecological, landscape, cultural or other related value	NO	
2	Areas which are important or sensitive for ecological reasons - Wetlands, watercourses or other water bodies, coastal zone, biospheres, mountains, forests.	YES	Momidi Reserved Forest is at distance of 71 m in East direction. Kottapatnam Reserved Forest is at distance of 4.7 km in NE direction. Udatavaripalem Protected Forest is at distance of 8.1 km in SW direction. Tammenapatnam Reserved Forest is at distance of 7.6 km in NE direction. Kandleru or Upputeru River is flowing at a distance of 3.3 km in NW direction. Buckingham Canal is flowing 3.6 km in East direction. Challa Kaluva is flowing at a distance of 9.8 km in South direction. Bay of Bengal is at a distance of 7.6 km in East direction. Sona Kaluva is flowing at a distance of 55 m in east direction
3	Areas used by protected, important or sensitive species of flora or fauna for breeding, nesting, foraging, resting, over wintering, migration.	NO	
4	Inland, coastal, marine or underground waters	NO	
5	State, National boundaries	NO	
6	Routes or facilities used by the public for access to recreation or other tourist, pilgrim areas	NO	
7	Defence installations	NO	
8	Densely populated or built-up area	NO	The project impact area has no urban or semi-urban area.
9	Areas occupied by sensitive man-made land uses (<i>hospitals, schools, places of worship, community facilities</i>)	NO	The PIA consists of community facilities in various villages, however no major impact is anticipated, as the mine is away from the residential area.
10	Areas containing important, high quality or scarce resources (<i>ground water resources, surface resources,</i>	NO	

	<i>forestry, agriculture, fisheries, tourism, minerals)</i>		
11	Areas already subjected to pollution or environmental damage. <i>(those where existing legal environmental standards are exceeded)</i>	NO	The area is undeveloped and consists of very few industries.
12	Areas susceptible to natural hazard which could cause the project to present environmental problems <i>(earthquakes, subsidence, landslides, erosion, flooding or extreme or adverse climatic conditions)</i>	NO	

(IV) Proposed Terms of Reference**Environment Management Plan and Mitigation Plan:**

The proposed mining project is proposed Silica Sand Mine in an area of 7.867 Ha located in Survey No. 451, Momidi Village, Chillakur Mandal, SPSR Nellore District, Andhra Pradesh State. In principle of application of quarry lease notice issued by Director of Mines and Geology, Ibrahimpattanam, Govt. of A.P for 20 years. Hence it is proposed to prepare an Environment Management Plan under B₂ category.

The Environment Management Plan shall identify typical impacts due to manual mining and a mining specialist shall work closely with the engineering team/technical consultants to suggest practicable measures to avoid or mitigate the impact. The mitigation of environmental impacts will be by three mechanisms.

=>Introduction of mitigation features through the engineering practices.

=>Implementation of environmental controls during construction and operation.

=>Legislative control involving compliance with Indian environmental laws.

The Environmental management plan shall include an estimate of capital and recurring costs of mitigation measures and will identify the institutional framework for implementation.

Monitoring Plan:

Having identified the significant environmental impacts that are likely to arise as a result of the project, the project team shall specify what monitoring is required during the various phases of the project cycle.

The monitoring plan will identify parameters and frequency of monitoring and responsible organization.

I hereby give the undertaking that data and information given in the application and enclosures are true to the best of my knowledge and belief and I am aware that if any part of the data and information submitted is found to be false or misleading at any stage, the project will be rejected and clearance give, if any to the project will be revoked at our risk and cost.

Date:

Place:

Signature of the applicant
With Name and Full Address
(Project Proponent/Authorised Signatory)

Sri Katamreddy Ravindra Reddy
D. No. 27-4-242, Flat No. 404,
Sai Ashraya Homes, Ramji Nagar,
SPSR Nellore - 524002
Mobile No. +91 99893 67070

ANNEXURES

ANNEXURE I

Site location map of M/s. K. K. Mines and Minerals

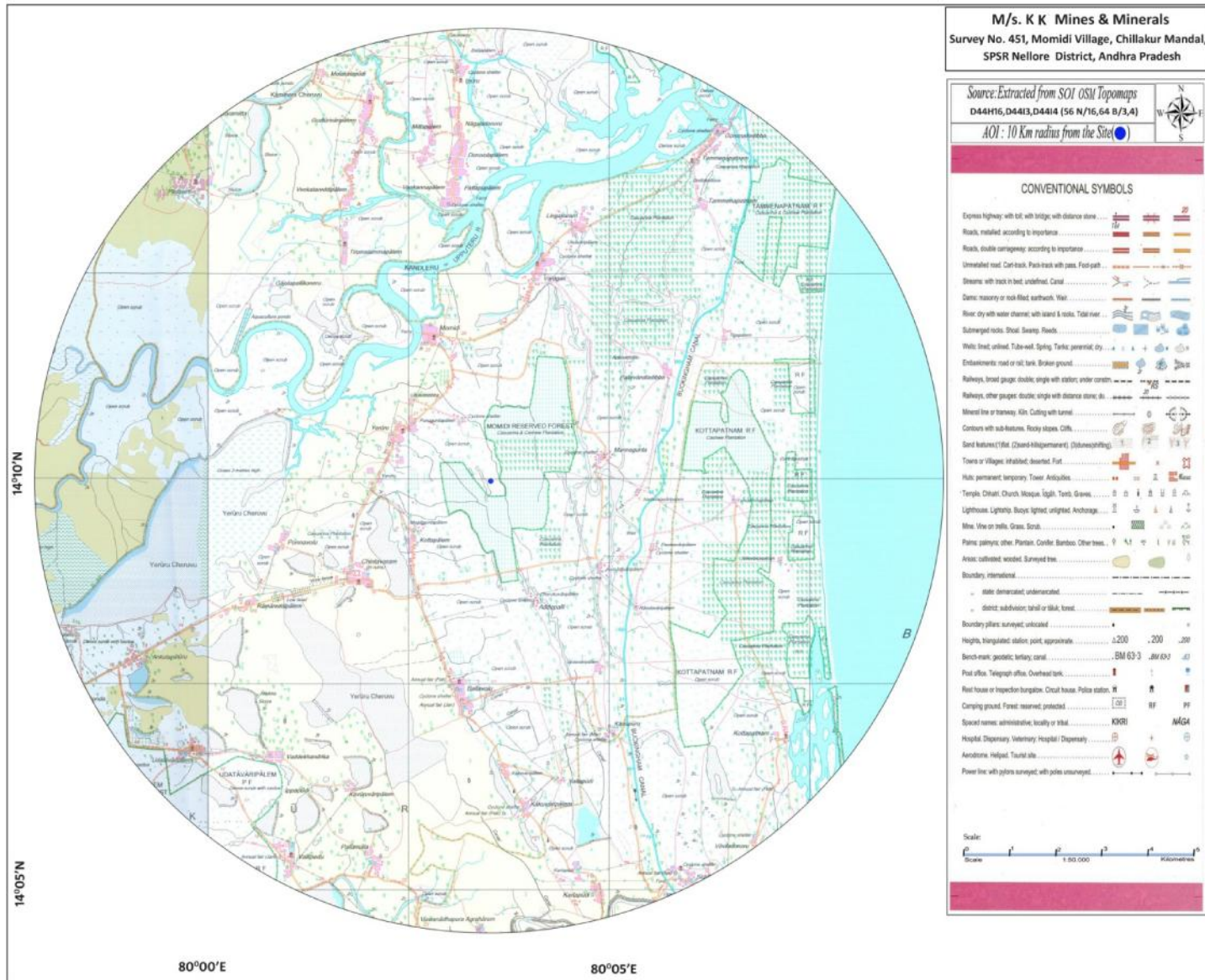

Quarry Lease area of M/s. K. K Mines & Minerals

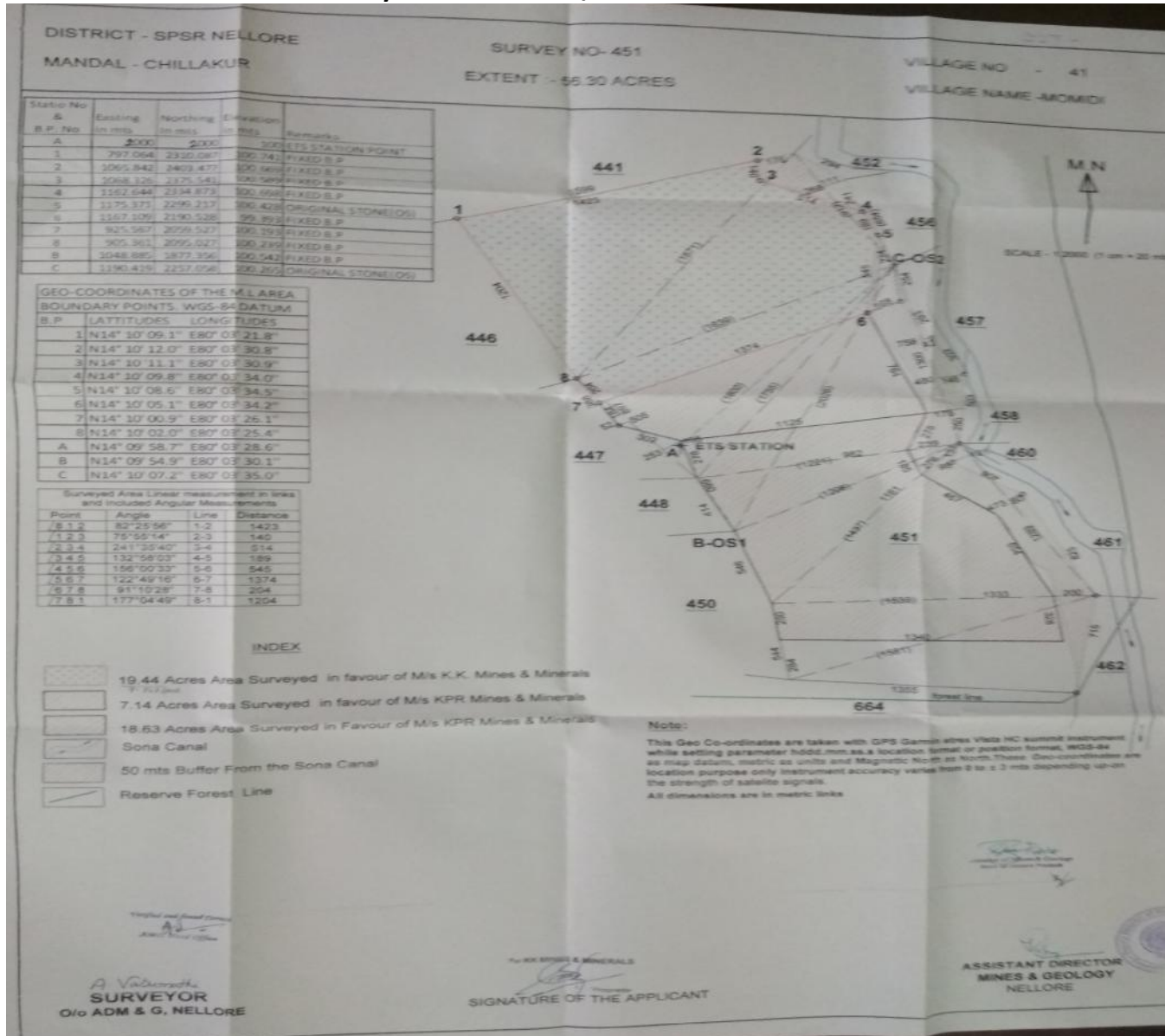

1.0 Introduction

M/s. K. K. Mines and Minerals proposes to conduct Manual open cast method quarrying for Silica Sand extraction in an area of 7.867 ha in Survey No. 451, Momidi Village, Chillakur Mandal, SPSR Nellore District, Andhra Pradesh. In principle grant of quarry lease notice was issued by Department of Mines and Geology, Ibrahimpatnam vide Notice no. 7079/R3-1/2018 dated 22.10.2018 for a period of 20 years. Mining Plan was approved by the Deputy Director of Mines and Geology, Government of Andhra Pradesh vide Letter no. 4861/MP/SS/NLR/2018 dated 23.11.2018. It is proposed to conduct Manual open cast method quarrying for Silica Sand production of 52290 TPA from the lease area. Capital proposed for the quarrying is Rs. 55 Lakhs. As per the ADMG letter, there are 13 mine leases within the 500 m surrounding area and total mine lease area in the cluster is 258.801 ha.

2.0 Mine Location

The proposed quarry lease area of 7.678 ha in Survey No. 451, Momidi Village, Chillakur Mandal, SPSR Nellore District, Andhra Pradesh. The quarry lease area falls in the Survey of India topo sheet no. 66 B/4 with the co-ordinates of Latitude 14°10'9.10"N and Longitude 80° 3'21.80"E with an elevation of 7m. Nearest village is Yeruru located at a distance of 2.0 km from the QL area in NW direction. Chintavarm to Momidi main road is passing at a distance of 2.3 km in West direction. Nearest Railway station and Town are Gudur is at a distance of 23 km in SW direction. Momidi Reserved Forest is at distance of 71 m in East direction. Kottapatnam Reserved Forest is at distance of 4.7 km in NE direction. Udatavaripalem Protected Forest is at distance of 8.1 km in SW direction. Tammenapatnam Reserved Forest is at distance of 7.6 km in NE direction. Kandleru or Upputeru River is flowing at a distance of 3.3 km in NW direction. Buckingham Canal is flowing 3.6 km in East direction. Challa Kaluva is flowing at a distance of 9.8 km in South direction. Bay of Bengal is at a distance of 7.6 km in East direction. Sona Kaluva is flowing at a distance of 55 m in east direction. There are no national/state boundary, national parks, wildlife sanctuaries and critically polluted areas observed in 10 km radius from the quarry lease area. Details of the mine lease area are presented in [table A-1](#).

Table A-1 Details of the Mine Lease area

State & District	Mandal	Village	Sy. No.	Extent in ha	Status of occupancy
Andhra Pradesh & SPSR Nellore	Chillakur	Momidi	451	7.867	Government Land

3.0 Mining**a) Type of Mining:**

In the applied area the mining activities is carried out by the manual open cast method by using small size of excavators for loading of silica sand. The silica sand is soft in nature, hence there is no need of drilling and blasting. However, it is proposed to work in the applied area from North to South side of the lease boundary by excavating two benches (i.e 1.5 m & 1 m). The water table has been encountered at a depth of 3.60 m. Hence, the proposed mining is confined up to depth of 2.5 m i.e., 1m above ground water table existing in the applied area. The maximum depth of the proposed mining is 2.5 m only. The bench height will be maintained 1.5m & 1 m and bench width will be maintained more than bench height.

b) Extent of Mechanization

- An excavator will be used for excavation of silica sand.
- A water tanker will be used to sprinkle water on mine roads, etc.
- Tippers will be used for transportation of mineral.

4.0 Employment Potential:

S. No.	Description	Number
1	Mines Manager/ Mate	1
2	Mining Supervisor/Clerk	2
3	Mine Watchman	2
4	Mining Labour	30
Total		35

5.0 Reserves

The reserves of Silica Sand are computed using Cross Sectional Area Method. Ten Cross Sections A-A' to H-H' were drawn perpendicular at equal distances of 30 m (Average) and cross sectional area each section multiplied with sectional influence (30 m) and Tonnage Factor 2.0 gives reserves. The detail calculation of reserves is given below.

Table A-2 Geological Reserves

Section	Sectional Area (m ²)	Cross section influence(m)	Volume (m ³)	Specific Gravity	Volume (Tonnage)
A-A'	852	30	25560	2	51120
B-B'	925	30	27750	2	55500
C-C'	1036	30	31080	2	62160
D-D'	1088	30	32640	2	65280
E-E'	1054	30	31620	2	63240
F-F'	1035	30	31050	2	62100
G-G'	980	30	29400	2	58800
H-H'	904	30	27120	2	54240
Total					472440

The reserves blocked under the buffer zone of 7.5m within the boundary area over an extent of= 8000 m² X 2.5 (depth) = 20000 m³X 2.0 (B.D)=40000 MT (not available for mining)

1.1 Mineable Reserves and Life of the Mine

Description	Quantity in Tons
Total Mineable Reserves	472440
Reserves Blocked in Buffer Zone	40000
Balance Reserves	432440
Annual Production	52290
Life of mine: Balance Reserves /Annual Production = 432440/52290 = 8.3 Years say 8 Years	

Production Plan

The sand is available in entire quarry lease area. However, it is proposed to work in the lease area by excavating two benches (i.e 1.5 m & 1 m). The maximum depth of the proposed mining is 2.5m only .The bench height will be maintained 1.5m & 1m and bench width maintained more than bench height. In this plan period it is proposed to raise about 260028 T tons of sand and a year wise production of 52290 T/year by advancing the south faces of the working towards north. Year wise production is presented in [table A-3](#).

Table A-3 Year wise production

Year	Section	Sectional Area (m ²)	Cross section influence (m)	Volume (m ³)	Specific Gravity	Volume (Ton)
1	A-A'	650	40	26000	2	52000
	Sub Total					52000
2	B-B'	694	20	13880	2	27760
	C-C'	764	16	12224	2	24448
	Sub Total					52208
3	D-D'	804	32	25728	2	51456
	Sub Total					51456
4	E-E'	789	33	26037	2	52074
	Sub Total					52074

5	F-F'	747	35	26145	2	52290
	Sub Total					52290
Grand Total						260028

ANNEXURE – II**Water Requirement**

Water requirement of 4.3 KLD for the project is mainly for Domestic source, maintaining the green belt and also for sprinkling on the haulage roads to mitigate dust emissions. The water shall be drawn from nearby villages. The water requirement of the project is presented in [table A-4](#).

Table A-4 Water Requirement

S. No	Water Usage	Quantity KLD
1	Water sprinkling on haul roads	2.2
2	Domestic Purpose	1.6
3	Green Belt	0.5
Total		4.3

Domestic effluent of 1.3 KLD shall send to septic tank followed by soak pit.

Site Services

Office, Rest Rooms, First Aid Room, Shelters, water for drinking will be provided in the Quarry premises on make shift arrangement.

Annexure III

Solid waste generation

No solid waste is generated in the mining.

Dump Area:

No dump areas are proposed in this mine.

K. K. MINES AND MINERALS

**SURVEY NO. 451, MOMIDI VILLAGE, CHILLAKUR MANDAL,
SPSR NELLORE DISTRICT, ANDHRA PRADESH**

Studies and Documentation by:

Team Labs and Consultants

(An ISO 9001:2008 Certified Company)

(MoE&F O.M. - S. NO: 25, List A-1)

B-115,116,117 & 509, Annapurna Block,

Aditya Enclave, Ameerpet, Hyderabad-500 038

Tel: 91-040-23748555, 23748616

Fax: 91-040-23748666.

Email: teamlabs@gmail.com