

FORM I

DFCCIL

INTIGRATED OFFICE CUM RESIDENTIAL COMPLEX

AT

SECTOR 145, NOIDA, UTTAR PRADESH

BY

**M/S DEDICATED FREIGHT CORRIDOR CORPORATION OF INDIA LTD.
MINISTRY OF RAILWAY (A GOVERNMENT OF INDIA ENTERPRISES)**

ENVIRONMENT CONSULTANT

OCEAO-ENVIRO Management Solutions (India) Pvt. Ltd.

QCI – NABET Certificate No: NABET/ELA/1821/IA 0033

217, 1st Floor, Sector 12, Vasundhara, Ghaziabad, U.P 201012

www.oceaoenviro.com | info@oceaoenviro.com

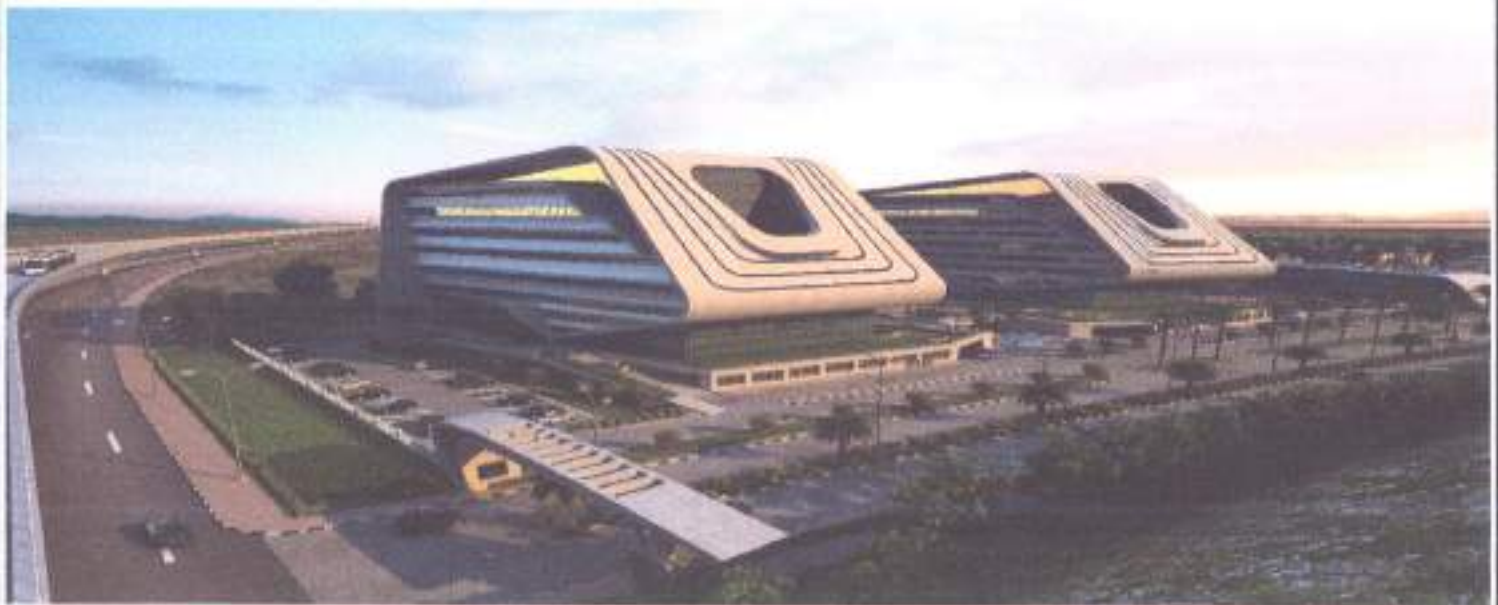

**M/s Dedicated Freight Corridor Corporation of India Ltd.
Ministry of Railway (A Government of India Enterprises)**



वाई. पी. शर्मा / Y.P. SHARMA

उप मुख्य परियोजना प्रबंधक/निर्देश/भारत
Dy. Chief Project Manager /Civil/NOIDA

डेडीकेटेड फ्रेट कोरीडोर कॉर्पोरेशन
Dedicated Freight Corridor Corporation

भारत सरकार रेल मंत्रालय का उपकरण
Ministry of Railway (A Government of India Enterprises)

INDEX

S. NO.	PARTICULATES	POINTS	PAGE
1.	Basic Information	I	4-5
2.	Activity	II	5-17
3.	Environmental Sensitivity	III	17-19
4.	Terms of Reference for EIA studies	IV	19



वाई. पी. शर्मा / Y. P. SHARMA

उप मुख्य परियोजना प्रबन्धक/सिविल/नएआ
Dy. Chief Project Manager /Civil/NOIDA

डेडीकेटेड फ्रेट कोरिडोर कॉर्पोरेशन
Dedicated Freight Corridor Corporation

भारत सरकार रेल मंत्रालय का उपक्रम
A Govt. India (Ministry of Railways) Enterprise



Integrated Office Cum Residential Complex

Located at Sector 145, Noida

Uttar Pradesh.

FORM I**(I) Basic Information**

S. No.	Item	Details
1.	Name of the project	"Integrated Office Cum Residential Complex" by M/s Dedicated Freight Corridor Corporation of India Ltd. Ministry of Railway (A Government of India Enterprises).
2.	S. No. in the schedule	8 (a): Building & Construction Project
3.	Proposed capacity/area/length/tonnage to be handled/command area/lease area/number of wells to be drilled	Total Plot Area = 1,68,491.00 m ² Plot area for Institutional Purpose = 141491.00 m ² Built Up Area for Institutional Purpose = 139350.00 m ² Plot area for Residential Purpose = 27000.00 m ² (Future Expansion)
4.	New/Expansion/Modernization	New
5.	Existing Capacity/Area etc.	Nil
6.	Category of Project i.e. 'A' or 'B'	Category B
7.	Does it attract the general condition? If yes, please specify.	No
8.	Does it attract the specific condition? If yes, please specify.	No
9.	Location Plot/Survey/Khasra No. Village Tehsil District State	Sector 145, Noida Jhatta Sadar / <i>G.B Nagar</i> Gautam Budh Nagar Uttar Pradesh
10.	Nearest railway station/airport along with distance in kms.	Nearest Airport: (i) Indira Gandhi International Airport Delhi which is approx. 33.00 Km away from the project site towards NW direction. (ii) Hindon Airforce Station which is approx. 25.5 km away from the project site towards N direction. Nearest railway station: (i) Dadri Railway Station, which is approx. 11.15 km away from the project site towards NE direction. (ii) Boraki Railway Station which is approx. 11.06 away from the project site towards NE direction. (Source of information: - Google Earth Image)

M/s Dedicated Freight Corridor Corporation of India Ltd.
Ministry of Railway (A Government of India Enterprises)

Y. P. SHARMA
उप मुख्य परियोजना प्रबंधक/सिविल/नोएडा
Chief Project Manager /Civil/NOIDA
डेडीकेड फ्रेट कोरिडोर कॉर्पोरेशन
Dedicated Freight Corridor Corporation

Integrated Office Cum Residential Complex

Located at Sector 145, Noida

Uttar Pradesh.

FORM I

11.	Nearest Town, city, District Headquarters along with distance in kms.	Nearest City: Greater Noida which is approx. 4.59 km away from the project site towards E direction Nearest Town: Surajpur which is approx. 5.35 km away from the project site towards NE direction District Headquarters: Collectorate Office Surajpur which is approx. 4.16 km away from the project site towards N direction
12.	Village Panchayats, Zilla Parishad, Municipal Corporation, Local body (complete postal addresses with telephone nos. to be given)	Municipal Corporation, Noida
13.	Name of applicant	M/s Dedicated Freight Corridor Corporation of India Ltd. Ministry of Railway (A Government of India Enterprises)
14.	Registered Address	5 th Floor, Pragati Maidan Metro Station Complex, New Delhi 110001.
15.	Address for correspondence: Name Designation (Owner/Partner/CEO) Address Pin Code Telephone No. E-mail	D-89, 1 st Floor, Sector 2, Noida Mr. Yogendra Pal Sharma Dy. Chief Project Manager D-89, 1 st Floor, Sector 2, Noida 201301 0120-2542889 ypsharma@dfcc.co.in
16.	Details of Alternative Sites examined, if any. Location of these sites should be shown on a toposheet.	No
17.	Interlinked Projects	No
18.	Whether separate application of interlinked project has been submitted?	No
19.	If yes, date of submission	Not Applicable
20.	If no, reason	Not Applicable
21.	Whether the proposal involves approval/ clearance under: if yes, details of the same and their status to be given. (a)The forest (Conservation) act, 1980? (b) The wildlife (Protection) act, 1972?	The Proposal involves clearance under (a)The forest (Conservation) act, 1980: NA (b) The wildlife (Protection) act, 1972: NA

M/s Dedicated Freight Corridor Corporation of India Ltd.
Ministry of Railway (A Government of India Enterprises)



काई. पी. शर्मा / Y. P. SHARMA
ज्य. मुख्य परियोजना प्रबंधक/सिविल/नोएडा
Dy. Chief Project Manager /Civil/NOIDA
डिडीकेडिआर कोरपोरेशन

Dedicated Freight Corridor Corporation
भारत सरकार रेल मंत्रालय का उपक्रम
A Govt. India (Ministry of Railways) Enterprise

Integrated Office Cum Residential Complex
 Located at Sector 145, Noida
 Uttar Pradesh.

FORM I

	(C) The C.R.Z Notification, 1991?	(C) The C.R.Z Notification, 1991: NA
22.	Whether there is any Government Order/Policy relevant/relating to the site?	1. NBC Guidelines 2016 2. Noida Bye Laws 2010 & its amendments 3. Construction Manual
23.	Forest land involved (hectares)	No
24.	Whether there is any litigation pending against the project and /or land in which the project is propose to be set up? (a) Name of the Court (b) Case No. (c) Orders/directions of the Court, if any and its relevance with the proposed project.	No

(II) Activity

1. Construction, operation or decommissioning of the Project involving actions, which will cause physical changes in the locality (topography, land use, changes in water bodies, etc.)

S. No.	Information/Checklist confirmation	Yes/No	Details thereof (with approximate quantities /rates, wherever possible) with source of information data
1.1	Permanent or temporary change in land use, land cover or topography including increase in intensity of land use (with respect to local land use plan)	No	Land has been allotted by New Okhla Industrial Development Authority on free hold basis for the purpose of Integrated Office Cum Residential Complex Project as per the Allotment letter Ref. no. <i>Infra/118/20174/196 dated 30.09.2014.</i> Therefore, No Permanent or temporary change in land use, land cover or topography including increase in intensity of land use occurs.
1.2	Clearance of existing land, vegetation and buildings?	No	The construction of project does not require any clearance of existing Land, Vegetation & Building.
1.3	Creation of new land uses?	No	Land has been allotted by New Okhla Industrial Development Authority on free hold basis for the purpose of Integrated Office Cum Residential Complex Project as per the Allotment letter Ref. no. <i>Infra/118/20174/196 dated 30.09.2014.</i>

M/s Dedicated Freight Corridor Corporation of India Ltd.
Ministry of Railway (A Government of India Enterprises)

 वाई. पी. शर्मा / Y. P. SHARMA
 Dy. Chief Project Manager / डिप्टी चीफ प्रोजेक्ट मैनेजर
 Dedicated Freight Corridor Corporation of India Ltd.
 भारत सरकार रेल मंत्रालय का उपक्रम
 (A Government of India Enterprise)

Integrated Office Cum Residential Complex

Located at Sector 145, Noida

Uttar Pradesh.

FORM I

			Therefore, there will be no creation of new land use.
1.4	Pre-construction investigations e.g. bore houses, soil testing?	Yes	Soil testing has been done during detailed engineering study
1.5	Construction works?	Yes	All construction activities will be confined within the project premises; there will be no physical changes outside the project boundary.
1.6	Demolition works?	No	Project site is vacant land. Demolition is not required.
1.7	Temporary sites used for construction works or housing of construction workers?	Yes	All the construction activity including stocking of raw materials will be confined within the project site only. Temporary labor hutments are proposed within the project site. Local labors from nearby area will be hired. Sanitation facilities will be developed at site.
1.8	Above ground buildings, structures or earthworks including linear structures, cut and fill or excavations	Yes	Approx. 18,5019.75 m ³ of soil will be excavated in a phase wise manner for foundation and for the basement of buildings. So, the total excavated quantity of earth material will be used in backfilling and other area development activities.
1.9	Underground works including mining or tunneling?	Yes	No underground works including mining/tunneling is required except excavation of earth.
1.10	Reclamation works?	No	No reclamation work required.
1.11	Dredging?	No	No dredging required.
1.12	Offshore structures?	No	No offshore structures required.
1.13	Production and manufacturing processes?	No	No production/manufacturing process involved as the project is a DFCCIL Integrated Office Cum Residential Complex Project.
1.14	Facilities for storage of goods or materials?	Yes	Raw material will be stored at site in a covered area. Cement will be separately stored in godowns. Sand will be stacked neatly under tarpaulin cover. Bricks and steel will be laid in covered area.
1.15	Facilities for treatment or disposal of solid waste or liquid effluents?	Yes	Solid Waste: The solid waste generated from the project will be in the form of:

 **शर्मा, पी. शर्मा / Y. P. SHARMA**

डि. प्रोजेक्ट मैनेजर / सिविल/नोडा
Dy. Chief Project Manager / Civil/NOIDA

डेडीकेटेड फ्रीट कोरिडोर कॉर्पोरेशन
Dedicated Freight Corridor Corporation

एक सरकारी एन.पी.ए. का उपक्रम
A Govt. India (Ministry of Railways) Enterprises

M/s Dedicated Freight Corridor Corporation of India Ltd.
Ministry of Railway (A Government of India Enterprises)



Integrated Office Cum Residential Complex
 Located at Sector 145, Noida
 Uttar Pradesh.

FORM I

			<p>Construction Waste: Left over cement mortar, cement concrete blocks, aggregate, sand and other inorganic material will be recycled and reused as granular sub base (GSB) layer of pavement. Earth rendered surplus from the excavation will be utilized in the backfilling & landscape.</p> <p>Operational Phase: The solid waste generated will be from project is mainly domestic in nature and the quantity of the waste will be 3061 kg/day. Solid wastes generated segregated into biodegradable (waste vegetables and foods etc.) and recyclable (papers, cartons, thermocol, plastics, glass etc.) components and collected in separate bins. The biodegradable organic wastes being treated inside the premises. Recyclable and non-recyclable wastes being disposed through Govt. approved agency.</p> <p>Liquid effluents: During construction phase, sewage has been treated and disposed through septic tanks with soak pits. The wastewater in operation phase will be treated up to tertiary level through STP of 400 KLD capacities (In phase wise manner) and the treated sewage being reused for toilet flushing and horticulture. Dewatered/dried sludge generated from the STP plant will be used as manure for green belt development.</p>
1.16	Facilities for long term housing of operational workers?	No	Local labourers will be hired from nearby areas during construction phase temporary hutments with Sanitation facilities will be provided within the project site premises. Therefore, there will be no need to create permanent facilities for long-term housing of operational workers.
1.17	New road, rail or sea traffic during	No	The site is just adjacent and well

M/s Dedicated Freight Corridor Corporation of India Ltd.
 Ministry of Railway (A Government of India Enterprises)



(Signature)
 यशोवन्त शर्मा / Y. P. SHARMA
 Dy. Chief Project Manager / Civil/NOIDA
 डेडीकेटेड फ्रीट कोरिडोर कॉर्पोरेशन

Integrated Office Cum Residential Complex

Located at Sector 145, Noida

Uttar Pradesh.

FORM I

	construction or operation?		connected to Noida-Greater Noida Expressway. Internal roads and paths are developed for vehicular movements for transportation of construction material during construction phase whereas internal tracks and paths are developed for traffic circulation (to avoid any congestion) during operational phase.
1.18	New road, rail, air waterborne or other transport infrastructure including new or altered routes and stations, ports, airports etc?	No	The site is just adjacent and well connected to Noida-Greater Noida Expressway. Nearest railway station which is Boraki 11.06 km away from the project site towards NE direction. The nearest airport is Hindon Airforce Station, which is approx. 25.5 km away from the project site towards N direction. Therefore, none of new road, rail, air waterborne or other transport infrastructure including new or altered routes and stations, ports, airports etc. is required.
1.19	Closure or diversion of existing transport routes or infrastructure leading to changes in traffic movements?	No	Since the site is just adjacent to Noida-greater Noida expressway which has low traffic density therefore, there is no need for diversion or closure of existing traffic routes.
1.20	New or diverted transmission lines or pipelines?	No	There will not be any diversion transmission lines or pipelines around the project.
1.21	Impoundment, damming, culverting, realignment or other changes to the hydrology of watercourses or aquifers?	No	No impoundment, damming, culverting, realignment or other changes to the hydrology of surface watercourses is proposed.
1.22	Stream crossings?	No	There are no streams running across the site.
1.23	Abstraction or transfers of water from ground or surface waters?	Yes	During construction phase, water requirement will be met through private water tankers and whereas during operation phase approx. 355 KLD (In phase wise manner) of fresh water will be

M/s Dedicated Freight Corridor Corporation of India Ltd.
Ministry of Railway (A Government of India Enterprises)



वाई पी शर्मा / Y. P. SHARMA
मुख्य परियोजना प्रबंधक/सिविल/नोएडा
Dy. Chief Project Manager/Civil/NOIDA
डेडीकेड फ्रेट कोरिडोर कॉर्पोरेशन
Dedicated Freight Corridor Corporation
भारत सरकार रेल मंत्रालय का उपक्रम
A Govt. India (Ministry of Railways) Enterprises

Integrated Office Cum Residential Complex
 Located at Sector 145, Noida
 Uttar Pradesh.

FORM I

2. Use of Natural resources for construction or operation of the Project (such as land, water, materials or energy, especially any resources which are non-renewable or in short supply):

S. No.	Information/checklist confirmation	Yes/No	Details thereof (with approximate quantities/rates, wherever possible) with source of information data
2.1	Land especially undeveloped or agricultural land (ha)	No	Land has been allotted by New Okhla Industrial Development Authority on free hold basis for the purpose of Integrated Office Cum Residential Complex Project as per the Allotment letter Ref. no. <i>Infra/118/20174/ 196 dated 30.09.2014</i> . Therefore, No Permanent or temporary change in land use, land cover or topography including increase in intensity of land use occurs.
2.2	Water (expected source & competing users) unit: KLD	Yes	During construction phase, approx. 1951 KLD amount of water will be required which will be provided by private water tanker (In phase wise manner) During operation phase, water supply will be provided through Municipal Corporation/ bore wells about 355 KLD (In phase wise manner) of fresh water will be required during operation phase of the project.
2.3	Minerals (MT)	Yes	Minerals such as sand and aggregates will be required during the construction phase.
2.4	Construction material – stone, aggregates, and / soil (expected source – MT)	Yes	All materials for construction will be arranged through authorized suppliers/ vendors.
2.5	Forests and timber (source – MT)	Yes	All material forests and timber will be provided by authorized suppliers/ vendors. However, steel frames etc., shall be used to minimize the use of timber.
2.6	Energy including electricity and fuels (source, competing users) Unit: fuel (MT), energy (MW)	Yes	The total demand load is estimated at approx. 9095.41 KW (In phase wise manner). Power back up in the Integrated Office Cum Residential Complex Project will be through 9 number of D.G sets of total capacity 8115 KVA (In phase wise manner), (3×1500 KVA, 3×750 KVA, 2×500 KVA and 1×365 KVA) for power

M/s Dedicated Freight Corridor Corporation of India Ltd.
 Ministry of Railway (A Government of India Enterprises)



(Signature)
 आई. पी. शर्मा / Y. P. SHARMA
 उपायुक्त परियोजना प्रबन्धक/डिप्टि/नोएडा
 Dy. Chief Project Manager, CFC/NOIDA
 डेडीकेटेड फ्रीट कॉरिडोर कॉर्पोरेशन
 Dedicated Freight Corridor Corporation
 भारत सरकार रेल मंत्रालय का उपक्रम

Integrated Office Cum Residential Complex
 Located at Sector 145, Noida
 Uttar Pradesh.

FORM I

			back up.
2.7	Any other natural resources (use appropriate standard units)	No	Not Applicable

3. Use, storage, transport, handling or production of substances or materials, which could be harmful to human health or the environment or raise concerns about actual or perceived risks to human health.

S. No.	Information/Checklist confirmation	Yes/No	Details thereof (with approximate quantities/rates, wherever possible) with source of information data
3.1	Use of substances or materials, which are hazardous (as per MSIHC rules) to human health or the environment (flora, fauna, and water supplies)	Yes	Diesel for DG sets will be stored in HDEP drums in earmarked locations. It shall also be handled as per The Manufacture, Storage and Import of Hazardous Chemical Rules, 1989 and Material Safety Data Sheet.
3.2	Changes in occurrence of disease or affect disease vectors (e.g. insect or water borne diseases)	No	Suitable drainage and waste management measures (with frequent spray of insecticides etc.) will be adopted in both the construction and operational phase such that there will be no stagnation of water or accumulation of waste. This will effectively restrict the reproduction and growth of disease vectors.
3.3	Affect the welfare of people e.g. by changing living conditions?	Yes	Socio-economic standard of people will improve due to increased employment opportunities provided by this project. This will lead to better quality of life and will also set a standard for future developments in the area.
3.4	Vulnerable groups of people who could be affected by the project e.g. hospital patients, children, the elderly etc.	No	Impacts of this type are not expected.
3.5	Any other causes	No	Not Applicable

M/s Dedicated Freight Corridor Corporation of India Ltd.
Ministry of Railway (A Government of India Enterprises)

 Y. P. SHARMA
 सचिव/मुख्य परियोजना प्रबन्धक/सिविल/नएडए
 Dy. Chief Project Manager /Civil/NOIDA
 डेडीकेटेड फ्रीट कॉरिडोर कॉर्पोरेशन
 भारत सरकार रेल मंत्रालय का उपक्रम
 A Govt. India (Ministry of Railways) Enterprises

4. Production of solid wastes during construction or operation or decommissioning
 (MT/month)

S. No.	Information/Checklist confirmation	Yes/No	Details thereof (with approximate quantities/rates, wherever possible) with source of information data								
4.1	Spoil, overburden or mine wastes	No	No such spoil, overburden or mine wastes will be generated.								
4.2	Municipal waste (domestic and or commercial wastes)	Yes	The total municipal (domestic) solid waste to be generated is approx. 3061 kg/day (In phase wise manner). <table border="1" style="margin-left: 20px;"> <tr> <td>Biodegradable waste (50%)</td> <td>1530.5 kg/day (Waste vegetables and foods etc.)</td> </tr> <tr> <td>Recyclable waste (40%)</td> <td>1224.4 kg/day (Papers, cartons, thermocol, plastics, glass etc.)</td> </tr> <tr> <td>Inert waste (10%)</td> <td>306.1 kg/day</td> </tr> <tr> <td>Total</td> <td>3061 kg/day</td> </tr> </table>	Biodegradable waste (50%)	1530.5 kg/day (Waste vegetables and foods etc.)	Recyclable waste (40%)	1224.4 kg/day (Papers, cartons, thermocol, plastics, glass etc.)	Inert waste (10%)	306.1 kg/day	Total	3061 kg/day
Biodegradable waste (50%)	1530.5 kg/day (Waste vegetables and foods etc.)										
Recyclable waste (40%)	1224.4 kg/day (Papers, cartons, thermocol, plastics, glass etc.)										
Inert waste (10%)	306.1 kg/day										
Total	3061 kg/day										
4.3	Hazardous wastes (as per Hazardous Waste Management Rules)	Yes	The hazardous wastes along with other wastes in the project will be used oil from DG sets, which is classified as per The Hazardous Waste Category 5.1 as per The Hazardous Wastes (Management, Handling and Transboundary movement) Rules, 2016. Used oil from DG sets will be stored in HDPE drums in isolated covered facility. This used oil will be sold to authorized recyclers. Suitable care will be taken so that spills/leaks of used oil from storage are avoided.								
4.4	Other industrial process wastes	No	Not applicable								
4.5	Surplus product	No	Not applicable								
4.6	Sewage sludge or other sludge from effluent treatment	Yes	Sludge generated from the STP plant will be dried and later will be used as manure for green belt development.								
4.7	Construction or demolition wastes	Yes	The construction waste will consist of excess earth and construction debris								



(Handwritten Signature)

Integrated Office Cum Residential Complex
 Located at Sector 145, Noida
 Uttar Pradesh.

FORM I

			along with cement bags, steel in bits and pieces, insulating and packaging materials etc. Recyclable waste construction materials will be sold to recyclers. Unusable and excess construction debris will be disposed at designated places in tune with the local norms.
4.8	Redundant machinery or equipment	No	Redundant machinery will not be generated.
4.9	Contaminated soils or other materials	No	Contaminated soils or other materials will not be generated.
4.10	Agricultural wastes	Yes	Landscape wastes of 2.92 kg/day will be generated (In phase wise manner)
4.11	Other solid wastes	No	Not Applicable

5. Release of pollutants or any hazardous, toxic or noxious substances to air (Kg/hr).

S. No.	Information/Checklist confirmation	Yes/No	Details thereof (with approximate quantities/rates, wherever possible) with source of information data
5.1	Emissions from combustion of fossil fuels from stationary or mobile sources	Yes	The project does not envisage any major air pollution sources except operation of DG sets during power failure and vehicular traffic.
5.2	Emissions from production processes	No	No production processes involved. Hence, there will be no such emissions.
5.3	Emissions from materials handling including storage or transport	Yes	Small quantities of fugitive emissions are envisaged during transport and handling of construction materials. Such emissions will be temporary and controlled by the use of sprinkling and other viable techniques like covering of loose material.
5.4	Emissions from construction activities including plant and equipment	Yes	This will be restricted to the construction phase and the construction site only.
5.5	Dust or odours from handling of materials including construction materials, sewage and waste	Yes	Dust is anticipated during loading and unloading of construction material and excavation of upper earth surface. These will however be temporary in nature, which will be controlled by providing water sprinklers. Tarpaulin cover will be provided on stored loose materials to

M/s Dedicated Freight Corridor Corporation of India Ltd.
Ministry of Railway (A Government of India Enterprises)



वाई. पी. शर्मा / Y. P. SHARMA
 Dy. Chief Project Manager (Civil/NOE) A
 13

Dedicated Freight Corridor Corporation
 भारत सरकार रेल मंत्रालय का उपकरण

			reduce the dust emission.
5.6	Emissions from incineration of waste	No	No incineration of wastes is proposed.
5.7	Emissions from burning of waste in open air (e.g. slash materials, construction debris)	No	Open burning of biomass/other material will be prohibited at the site.
5.8	Emissions from any other sources	No	Not Applicable

6. Generation of Noise and Vibration, and Emissions of Light and Heat:

S. No.	Information/Checklist confirmation	Yes/No	Details thereof (with approximate quantities/ rates, wherever possible) with source of information data
6.1	From operation of equipment e.g. engines, ventilation plant, crushers	Yes	Source of Noise in the operational phase will be from D.G sets (which will be in operation only during power failure) and pumps & motors. All the machinery will be of highest standard of reputed make and will comply with standard i.e. The DG set room will be provided and D.G set will be of acoustic enclosure to have minimum 25 dB (A) insertion loss or for meeting the ambient noise standard whichever is on higher side as per E (P) Act, GSR 371 (E) and its amendments. Therefore, no significant impact due to operation of machinery is anticipated.
6.2	From industrial or similar processes	No	No industrial processes will be carried out in the project.
6.3	From construction or demolition	Yes	Due to various construction activities, there will be short-term noise impacts in the immediate vicinity of the project site. The construction activities will include the following noise generating activities: <ul style="list-style-type: none"> • Concreting, mixing & operation of DG sets along with vehicle movement.
6.4	From blasting or piling	No	No blasting or mechanized piling will be done.
6.5	From construction or operational traffic	Yes	Some noise will be generated from vehicular movement in the construction but that will be mitigated with green belt.



Integrated Office Cum Residential Complex

Located at Sector 145, Noida

Uttar Pradesh.

FORM I

6.6	From lighting or cooling systems	No	No significant noise impact will result from lighting or cooling systems.
6.7	From any other sources	No	Not Applicable

7. Risks of contamination of land or water from releases of pollutants into the ground or into sewers, surface waters, groundwater, coastal waters or the sea:

S. No.	Information/Checklist confirmation	Yes/No	Details thereof (with approximate quantities/rates, wherever possible) with source of information data
7.1	From handling, storage, use or spillage of hazardous materials	No	The used oil from DG sets will be carefully stored in HDPE drums at isolated storage, and periodically sold to authorized recyclers. All precautions will be taken to avoid spillage from storage as per The Hazardous Wastes (Management, Handling and Trans boundary movement) Rules, 2016.
7.2	From discharge of sewage or other effluents to water or the land (expected mode and place of Discharge)	No	There will be no discharge of untreated sewage on land or into water bodies. Adequate treatment of sewage will be carried out in a STP having capacity of 400 KLD (In phase wise manner) which in proposed within the project premises. Treated sewage will be re-used for flushing, D.G cooling, HVAC, horticulture etc.
7.3	By deposition of pollutants emitted to air into the land or into water	No	The DG Sets will be provided with stacks of adequate height. Hence dispersion will be achieved and avoid deposition of pollutants in significant concentrations at any single location.
7.4	From any other sources	No	Not Applicable
7.5	Is there a risk of long term build up of pollutants in the environment from these sources?	No	Not Applicable



वाई. पी. शर्मा / Y. P. SHARMA

प्र. प्र. परियोजना प्रबन्धक/सिविल/नोएडा

Dy. Chief Project Manager / Civil/NOIDA

डेडीकेटेड फ्रीट कोरिडोर कॉर्पोरेशन

Dedicated Freight Corridor Corporation

भारत सरकार रेल मंत्रालय का उपक्रम

A Govt. India (Ministry of Railways) Enterprise

M/s Dedicated Freight Corridor Corporation of India Ltd.
Ministry of Railway (A Government of India Enterprises)

Integrated Office Cum Residential Complex

Located at Sector 145, Noida

Uttar Pradesh.

FORM I**8. Risk of accidents during construction or operation of the Project, which could affect human health or the environment**

S. No.	Information/Checklist confirmation	Yes/No	Details thereof (with approximate quantities/rates, wherever possible) with source of information data
8.1	From explosions, spillages, fires, etc. from storage, handling, use or production of hazardous substances	Yes	To deal with any fire related accident, fire fighting facility of single handed hydrant valve, long hose reel, and portable fire extinguisher shall be provided.
8.2	From any other causes	No	Not Anticipated
8.3	Could the project be affected by natural disasters causing environmental damage (e.g. floods, earthquakes, landslides, cloudburst etc.)	Yes	The project falls under seismic active Zone IV indicating very high damage risk zone. The buildings will be designed as earthquake resistant and comply with the required IS specifications.

9. Factors which should be considered (such as consequential development) which could lead to environmental effects or the potential for cumulative impacts with other existing or planned activities in the locality

S. No.	Information/Checklist confirmation	Yes/No	Details thereof (with approximate quantities/rates, wherever possible) with source of information data
9.1	Lead to development of supporting, utilities, ancillary development or development stimulated by the project which could have impact on the environment e.g.: • Supporting infrastructure (roads, power supply, waste or waste water treatment, etc.)	Yes	Appropriate infrastructure like roads, power supply, waste management and waste water treatment will be developed within the project site. Land has been allotted by New Okhla Industrial Development Authority on free hold basis for the purpose of Integrated Office Cum Residential Complex Project. Proposed project is Institutional part of the project and Residential part of the project is proposed in future expansion.
	• Housing development	No	No Housing development.
	• Extractive industries	No	No Extractive industries

M/s Dedicated Freight Corridor Corporation of India Ltd.
Ministry of Railway (A Government of India Enterprises)



वाई. पी. शर्मा / Y. P. SHARMA
उप मुख्य परियोजना अधिकारी/सिडिल/नोएडा
Dy. Chief Project Manager /CID/SIDDA
डिडीकोरेड फ्रीट कॉरिडोर कॉर्पोरेशन
Dedicated Freight Corridor Corporation
एनएच, एनएच, डेव, एनएच, एनएच, एनएच



Integrated Office Cum Residential Complex
 Located at Sector 145, Noida
 Uttar Pradesh.

FORM I

	<ul style="list-style-type: none"> Supply industries Other 	<p>No</p> <p>Yes</p>	<p>No Supply industries</p> <p>Institutional</p>
9.2	Lead to after-use of the site, which could have an impact on the environment	No	Not Anticipated
9.3	Set a precedent for later developments	Yes	The project will provide good opportunity for the people and better life style and will set an example for later developments in the areas.
9.4	Have cumulative effects due to proximity to other existing or planned projects with similar effects	No	Not Applicable

(III) Environmental Sensitivity

S. No.	Areas	Name/ Identity	Aerial distance (within 15 km) Proposed project location boundary
1	Areas protected under international conventions, national or local legislation for their ecological, landscape, cultural or other related value	None	There is no such area lies within 15 km radius of the project site.
2	Areas which are important or sensitive for ecological reasons - Wetlands, watercourses or other water bodies, coastal zone, biospheres, mountains, forests	<p>Surajpur Wetland</p> <p>Gulistanpur Reserve forest</p> <p>Sikargah Reserve Forest</p> <p>Rajpur Reserve Forest</p> <p>Mubarikpur Reserve Forest</p>	<p>Surajpur Wetland is approx. 6 km away from the project site towards NE direction</p> <p>Gulistanpur Reserve forest is approx. 5.18 km away from the project site towards E direction.</p> <p>Sikargah Reserve forest is approx. 5.34 km away from the project site towards S direction</p> <p>Rajpur Reserve forest is approx. 5.34 km away from the project site towards S direction.</p> <p>Mubarikpur Reserve forest is approx. 54.80 m away from the project site towards N direction.</p>

M/s Dedicated Freight Corridor Corporation of India Ltd.
Ministry of Railway (A Government of India Enterprises)

 Y. P. SHARMA
 उप मुख्य परियोजना प्रबन्धक/सिविल/नई दिल्ली
 Chief Project Manager / Civil / New Delhi
 डेडीकेटेड फ्रीट कोरिडोर कॉर्पोरेशन
 Dedicated Freight Corridor Corporation
 भारत सरकार रेल मंत्रालय का उप
 Ministry of Railways

Integrated Office Cum Residential Complex

Located at Sector 145, Noida

Uttar Pradesh.

FORM I

		Yamuna River	Yamuna River is approx. 2.67 km away from the project site towards SW direction.
		Hindan River	Hindan River is approx. 1.00 km away from the project site towards S direction.
3	Areas used by protected, important or sensitive species of flora or fauna for breeding, nesting, foraging, resting, over wintering, migration	None	There is no such area lies within 15 km radius of the project site
4	Inland, coastal, marine or underground waters	Ground water	The depth of groundwater is 7.3 m bgl below the ground level.
5	State, National boundaries	Delhi – Uttar Pradesh State Boundary Haryana – Uttar Pradesh State Boundary	Delhi – Uttar Pradesh State Boundary is approx. 13.87 km away from the project site towards W direction. Haryana – Uttar Pradesh State Boundary is approx. 2.82 km away from the project site towards SW direction.
6	Routes or facilities used by the public for access to recreation or other tourist, pilgrim areas	Noida- Greater Noida expressway	Noida - Greater Noida Expressway is Just Adjacent to the project site towards SW direction
7	Defense installations	Hindon Airforce Station	Hindon Airforce Station is approx. 25.5 km away from the project site towards N direction.
8	Densely populated or built-up area	Greater Noida	Greater Noida which is approx. 4.59 km away from the project site towards E direction.
9	Areas occupied by sensitive man-made land uses (<i>hospitals, schools, places of worship, community facilities</i>)	Kailash Hospital Greater Noida ITS Surya Hospital Shiv Nadar School	Kailash Hospital Greater Noida is approx. 4.63 km away from the project site towards E direction. ITS Surya Hospital is approx. 2.9 km away from the project site towards E direction. Shiv Nadar School is approx. 4.4 km away from the project site towards NW direction. IIMT College of Engineering is approx. 3.43 km away from the



Integrated Office Cum Residential Complex
 Located at Sector 145, Noida
 Uttar Pradesh.

FORM I

		<p>IIMT College of Engineering</p> <p>Greater Noida Institute of Technology</p> <p>Hare Krishna Temple</p>	<p>project site towards NE direction.</p> <p>Greater Noida Institute of Technology is approx. 4.13 km away from the project site towards E direction.</p> <p>Hare Krishna Temple is approx. 0.9 km away from the project site towards W direction.</p>
10	<p>Areas containing important, high quality or scarce resources. (<i>ground water resources, surface resources, forestry, agriculture, fisheries, tourism, minerals</i>)</p>	None	There are no areas within 15 km containing important, high quality or scarce resources.
11	<p>Areas already subjected to pollution or environmental damage. (<i>those where existing legal environmental standards are exceeded</i>)</p>	None	There are no areas within 15 km which are subjected to pollution or environmental damage.
12	<p>Areas susceptible to natural hazard which could cause the project to present environmental problems (<i>earthquakes, subsidence, landslides, erosion, flooding or extreme or adverse climatic conditions</i>)</p>	Earthquakes	The site falls under the zone IV as per the Seismic Zone Map of India and is thus prone to high damage risk zone. Adequate measures were taken during the construction of the project.

(IV) **Terms of Reference for EIA studies** - Not Applicable for 8(a) category of Building and construction project.



वाई. पी. शर्मा / Y. P. SHARMA
 उप मुख्य परियोजना प्रबंधक/सिडिल/नोएडा
 Dy. Chief Project Manager /DVI/NOIDA

डेडीकेटेड फ्रीट कोरिडोर कॉर्पोरेशन
 Dedicated Freight Corridor Corporation
 भारत सरकार रेल मंत्रालय का उपक्रम
 Govt. India (Ministry of Railways) Enterprise.

M/s Dedicated Freight Corridor Corporation of India Ltd.
 Ministry of Railway (A Government of India Enterprises)

Integrated Office Cum Residential Complex

Located at Sector 145, Noida

Uttar Pradesh.

FORM I

"I hereby give undertaking that the data and information given in the application and enclosures are true to the best of my knowledge and belief and I am aware that if any part of the data and information submitted is found to be false or misleading at any stage, the project will be rejected and clearance given, if any to the project will be at our risk and cost.

Date: 10.12.2018

Place: Noida



वाई. पी. शर्मा / Y. P. SHARMA

उप मुख्य परियोजना प्रबन्धक/सिविल/मेट्रो

Dy. Chief Project Manager /Civil/NOIDA

डेडीकेटेड फ्रेट कोरिडोर कॉर्पोरेशन

Dedicated Freight Corridor Corporation

भारत सरकार रेल मंत्रालय का उपक्रम

A Govt. India (Ministry of Railways) Enterprise

Signature of the Applicant

Mr. Yogendra Pal Sharma

Dy. Chief Project Manager

D-89, 1st Floor, Sector 2, Noida, 201301

NOTE:

1. The Projects involving clearance under Coastal Regulation Zone Notification, 1991 shall submit with the application a C.R.Z map duly demarcated by one of the authorized agencies, showing the project activities, w.r.t. C.R.Z. and the recommendations of the state Coastal Zone management Authority. Simultaneous action shall also be taken to obtain the requisite clearance under the provisions of the C.R.Z. Notification, 1991 for the activities to be located in the CRZ.
2. The projects to be located within 10 km of the National Parks, Sanctuaries, Biosphere Reserves, Migratory Corridors of Wild Animals, the project proponent shall submit the map duly authenticated by Chief Wildlife Warden showing these features vis-à-vis the project location and the recommendations or comments of the Chief Wildlife Warden thereon."
3. All correspondence with the Ministry of Environment & Forests including submission of application for TOR/ Environmental Clearance, subsequent clarifications, as may be required from time to time, participation in the EAC Meeting on behalf of the project proponent shall be made by the authorized signatory only. The authorized signatory should also submit a document in support of his claim of being an authorized signatory for the specific project".



वाई. पी. शर्मा / Y. P. SHARMA

उप मुख्य परियोजना प्रबन्धक/सिविल/मेट्रो

Dy. Chief Project Manager /Civil/NOIDA

डेडीकेटेड फ्रेट कोरिडोर कॉर्पोरेशन

Dedicated Freight Corridor Corporation

भारत सरकार रेल मंत्रालय का उपक्रम

A Govt. India (Ministry of Railways) Enterprise

