

GOVERNMENT OF ANDHRA PRADESH
DEPARTMENT OF MINES AND GEOLOGY::IBRAHIMPATNAM

NOTICE NO.5427/R2-3/2018

Dated. .06.2018

Sub:- Mines & Quarries - Application for grant quarry lease for Quartz & Feldspar over an extent of 11.21 Acs/ 4.538 Hec in Sy.No. 108/1P & 2P of Kambampadu Village, A.Konduru Mandal, Krishna District filed by M/s VSR Mines and Minerals Pvt. Ltd., M/P:Sri S.RadhaKrishna Reddy - Approved Mining Plan along with consent for Establishment from A.P. Pollution Control Board & Environmental Clearance from Ministry of Environment & Forests as per Environment Impact Assessment Notification through S.O.1533, dated:14-09-2006 - Called for - Regarding.

- Ref:-
1. Quarry Lease Application dt. 30.01.2018 filed by M/s VSR Mines and Minerals Pvt. Ltd.,
 2. ADM&G, Vijayawada file.no.370/Q/2018, dt.02-05-2018.

Through the reference 1st cited M/s VSR Mines and Minerals Pvt. Ltd., M/P:Sri S.RadhaKrishna Reddy filed an application for Quartz & Feldspar over an extent of 11.21 Acs/ 4.538 Hec in Sy.No. 108/1P & 2P of Kambampadu Village, A.Konduru Mandal, Krishna District. The Quarry Lease application was received by the Assistant Director of Mines & Geology, Vijayawada on 30-01-2018.



Through the reference 2nd cited the Assistant Director of Mines & Geology, Vijayawada submitted proposals for grant of quarry lease for Quartz & Feldspar over an extent of 11.21 Acs/ 4.538 Hec in Sy.No. 108/1P & 2P of Kambampadu Village, A.Konduru Mandal, Krishna District in favour of the applicant for a period of 30 years.

After careful examination of the proposals of the ADM&G, Vijayawada it is decided in principle to grant quarry lease for Quartz & Feldspar over an extent of 11.21 Acs/ 4.538 Hec in Sy.No. 108/1P & 2P of Kambampadu Village, A.Konduru Mandal, Krishna District to M/s VSR Mines and Minerals Pvt. Ltd., M/P:Sri S.RadhaKrishna Reddy subject to submission of Approved Mining Plan as required under Rule 12(5) (c) of Andhra Pradesh Minor Mineral Concession Rules, 1966 along with Consent for Establishment from A.P. Pollution Control Board & Environment Clearance from Ministry of Environment & Forests as per Environment Impact Assessment Notification through S.O.1533, dated: 14-09-2006 within a period of (6) months from the date of issue of this notice.

The approved mining plan shall reflect the restrictions to be adopted by the applicant while conducting quarry operations due to the existence of any structures, railway line, roads, water bodies such as river, lake etc., and the stipulated distances as per the various Regulations prescribed under Metalliferous Mines Regulations, 1961 shall be adhered to. If the applicant firm desires to exploit the locked up mineral within the stipulated distance, he can do so with the permission from the Department of Mines Safety.

In view of the above, M/s VSR Mines and Minerals Pvt. Ltd., M.P:Sri S.RadhaKrishna Reddy is hereby requested to submit Mining Plan approved by the Deputy Director of Mines & Geology, Kakinada along with Consent for Establishment from A.P. Pollution Control Board & Environmental Clearance from Ministry of Environment & Forests as per Environment Impact Assessment Notification through S.O.1533, dated:14-09-2006 for the precise extent of 11.21 Acs (4.538 Hecs) proposed for grant of quarry lease within a period of 36 months from the date of issue of this notice to consider for grant of quarry lease for Fire clay in the subject area. If the applicant firm fails to submit the Approved Mining Plan within the stipulated period, it will be presumed that the applicant firm is not interested in getting the Quarry Lease over the subject area and further course of action will be initiated as per rules. A copy of the surveyed sketch showing the precise area of 11.21 Acs (4.538 Hecs) proposed for grant of quarry lease is enclosed herewith.

Encl: (Surveyed sketch)

DIRECTOR OF MINES & GEOLOGY(FAC)

11/6/18

11/6/18

To

VSR Mines and Minerals Pvt Ltd
Mg.Part:Sri S.Radha Krishna Reddy,
H.No.5-4-51/501, Dharani Residency,
Flat No.501, Alkapur Township,
Neknampur, Hyderabad - 500089.

--- (BY RPAD)

Copy to the Deputy Director of Mines and Geology, Kakinada for information.

Copy to the Assistant Director of Mines and Geology, Vijayawada.

Copy to stock file.

DISTRICT: KRISHNA
MANDAL: A.KONDURU

FIELD NO. 108 & 109

VILLAGE NO.46
VILLAGE NAME; KAMBAMPADU
AREA: 108 AC; 30.15

SCALE: 1CM=1CHAIN
1:2000

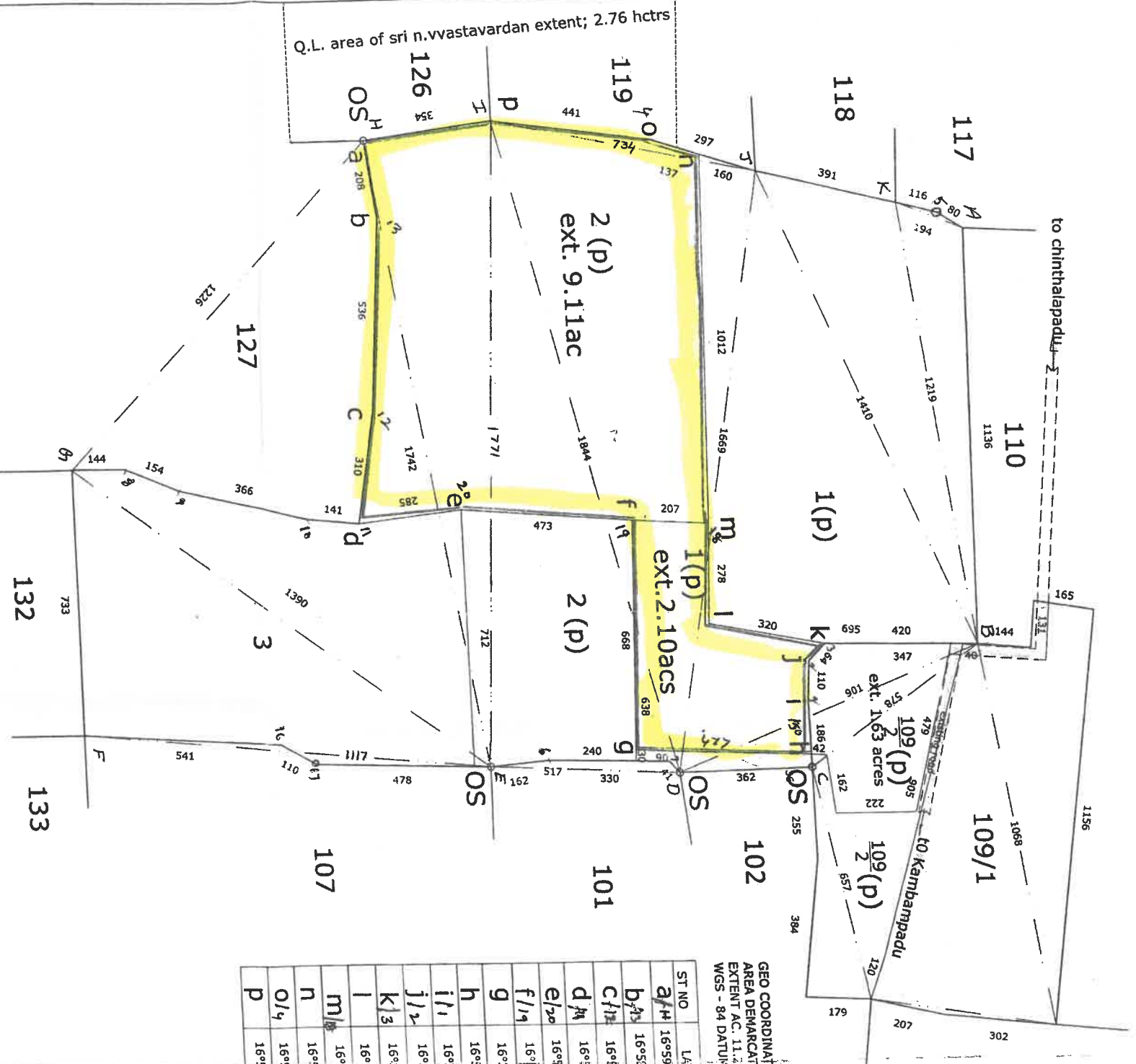

GEO COORDINATES OF THE AREA DEMARCATED IN R.S.NO.108/1(P) & 2(P) EXTENT AC. 11.21 CENTS OR 4.538 HECTRS IN WGS - 84 DATUM

ST NO	LATITUDE	LONGITUDE
a/H	16°59'30.35"N	80°38'20.37"E
b/H	16°59'30.12"N	80°38'21.75"E
c/H	16°59'28.85"N	80°38'25.10"E
d/H	16°59'27.94"N	80°38'26.96"E
e/H	16°59'29.77"N	80°38'27.33"E
f/H	16°59'32.60"N	80°38'28.47"E
g	16°59'31.27"N	80°38'32.57"E
h	16°59'34.20"N	80°38'33.68"E
i/H	16°59'34.46"N	80°38'32.67"E
j/H	16°59'34.72"N	80°38'31.99"E
k/H	16°59'35.11"N	80°38'31.78"E
l	16°59'33.25"N	80°38'30.74"E
m	16°59'33.87"N	80°38'28.98"E
n	16°59'35.94"N	80°38'22.55"E
o/H	16°59'35.22"N	80°38'22.01"E
p	16°59'32.62"N	80°38'20.76"E

LADDAR FOR R.S. NO.108

G	1226	
8	103	1125
9	246	1069
10	561	884
11	673	798
12	501	541
13	161	130
		H
	1742	
	711	67
		E
	1117	
	641	30
	16	16
	540	
	EP	94
		F
		1390
	F	587
		954
		702
		79
		EP
		E
		1771
		64
		346
		H
		D
		517
		7
		30
		489
		6
		23
		160
		E
		K
		194
		79
		14
		5
		A
		1844
		703
		74
		19
		635
		269
		18
		E
		495
		145
		D
		901
		C
		131
		564
		B
		J
		734
		4
		31
		440
		T
		B
		1410
		1050
		81
		TP
		K
		313
		233
		J
		B
		1219
		A
		169
		99
		K
		B
		578
		3
		249
		240
		2
		238
		176
		1
		154
		107
		C

E.T.S. DATA

ST NO	EASTING	NORTHING	ELEVATION
ST 1	2000	1000	100
stone	2083.1143	951.5608	100.262
a	1735.3932	929.8209	96.630
b	1776.7479	931.4441	97.232
c	1882.0465	914.3258	98.123
d	1941.7770	898.2761	99.120
e	1940.2169	955.2547	100.111
f	1955.8545	1047.6044	101.230
g	2082.4863	1032.1133	102.132
h	2094.8748	1126.8034	102.431
i	2064.6657	1129.2078	102.391
j	2043.2017	1132.6686	101.331
k	2034.8545	1142.6186	101.251
l	2017.0436	1081.1469	101.197
m	1961.9393	1088.5548	101.212
n	1762.5144	1111.5455	100.270
o	1751.9548	1086.5593	100.240
p	1732.3191	1000.5542	99.131

Q.L. APPLIED AREA DEMARCATED TO VSR MINES & MINERALS PVT. LTD., IN R.S.NO.108/ 1 (P) and 2 (P) EXT. AC. 11.21 OR 4.538 HECTRS

Verified and found Correct
RACO, Head Office

The Plans and Sections are prepared based on lease may authenticated by the State Government CORRECTNESS CERTIFIED

(P.V.SATYANARAYANA)
R.O.P./DMG/HP/347/2017
R.O.P./DMG/HYD/43/2017

Sketch Appended to Notice No. 5421/2018
Date: 11/06/2018

Director of Mines & Geology
Govt. of Andhra Pradesh

SURVEYOR
O/O ADMG, VJA

APPLICANT

ASST. DIRECTOR OF MINES & GEOLOGY
VIJAYAWADA

APPROVED

This Mining Plan is subject to the conditions and restrictions indicated in the Mining Plan and the letter No. 2581/Quantity/M.M. 1/2018 dated 14/11/2018

M. Babu Chandra Shekar
Director of Mines & Geology
VAKTANADA